

**NOTICE!!**

**These documents have been scanned!**

**Do not place un-scanned documents beneath this notice!**

**Do not remove this notice from this file!**

GPO Jacket No. 560-102  
Print Order 61540  
Rise Business Services, LLC  
Job=AZ15 5/10/2019



Box Number= AZ15035



Claim Begin-End: AMC426123-AMC426126

1 Initial Receipt



AZ15035-15

AMC425596-AMC426147

**United States Department of the Interior**  
**Bureau of Land Management**  
 LANDS/RECREATION & PLANNING  
 ONE N CENTRAL AVE  
 PHOENIX, AZ 85004 -2203  
 Phone: 602-417-9200

**ENTERED**  
 JAN 21 2014  
 BY: *JM*

Receipt

No: 2947681

<b>Transaction #:</b> 3035462	
<b>Date of Transaction:</b> 01/10/2014	
CUSTOMER:	
DEPARTMENT OF LAND TRANSFER INFORMATION INC 942 CALLE AMANECER BLDG B548 SAN CLEMENTE, CA 92673-6220 US	

LINE #	QTY	DESCRIPTION	REMARKS	UNIT PRICE	TOTAL
1	4.00	LOCATABLE MINERALS / MINING CLAIMS- NEW, UNADJUD, ONE OR MORE AUTH NOS / NEW MINING CLAIM LOCATION FEE \$34 <b>CASES:</b> AMC426123/\$34.00, AMC426124/\$34.00, AMC426125/\$34.00, AMC426126/\$34.00		- n/a -	136.00
2	4.00	LOCATABLE MINERALS / MINING CLAIMS- NEW, UNADJUD, ONE OR MORE AUTH NOS / NEW MINING CLAIM PROCESSING FEE <b>CASES:</b> AMC426123/\$20.00, AMC426124/\$20.00, AMC426125/\$20.00, AMC426126/\$20.00		- n/a -	80.00
3	4.00	LOCATABLE MINERALS / MINING CLAIMS- NEW, UNADJUD, ONE OR MORE AUTH NOS / NEW MINING CLAIM MAINT FEE \$140 <b>CASES:</b> AMC426123/\$140.00, AMC426124/\$140.00, AMC426125/\$140.00, AMC426126/\$140.00		- n/a -	560.00
<b>TOTAL:</b>					<b>\$776.00</b>

PAYMENT INFORMATION			
1	AMOUNT:	776.00	POSTMARKED: 01/09/2014
	TYPE:	CHECK	RECEIVED: 01/09/2014
	CHECK NO:	5028	
	NAME:	DEPARTMENT OF LAND TRANSFER INFORMATION 942 CALLE AMANECER BLDG B548 SAN CLEMENTE CA 92673-6220 US	

REMARKS

This receipt was generated by the automated BLM Collections and Billing System and is a paper representation of a portion of the official electronic record contained therein.

**NOTICE!!**

**These documents have been scanned!**

**Do not place un-scanned documents beneath this notice!**

**Do not remove this notice from this file!**

GPO Jacket No. 560-102  
Print Order 61540  
Rise Business Services, LLC  
Job=AZ15 5/10/2019



Box Number= AZ15035



Claim Begin-End: AMC426123-AMC426126

2 Correspondence



AZ15035-15

AMC425596-AMC426147



# United States Department of the Interior



BUREAU OF LAND MANAGEMENT

Arizona State Office

One North Central Avenue, Suite 800

Phoenix, Arizona 85004-4427

www.blm.gov/az/

OCT 07 2016

In Reply Refer To:

3800 (9200) RM

AMC425045, AMC425247, AMC425284,

AMC425597, AMC425919, AMC426116,

AMC426123, AMC427520, AMC429608,

AMC429642, AMC429994

CERTIFIED MAIL - RETURN RECEIPT REQUESTED No. 7016 1370 0001 2495 2868

## DECISION

JIM ED COTTLE SR

LISA CLOPTON

3478 CATCLAW DR PMB 228

ABILENE, TX 79606-8224

: This decision affects those claims shown  
: on the attached list(s).  
:

---

SEE ENCLOSURE FOR LIST OF CLAIMS

---

### MINING CLAIMS DECLARED FORFEIT

The mining claims listed above have been declared forfeit as of September 1, 2016, for failure to timely file the required maintenance fee payment or small miner's maintenance fee waiver (waiver).

Claimants are required to pay an annual non-refundable maintenance fee of \$155 per 20 acres or portion thereof, or submit a waiver, on or before September 1 of each year. These requirements were established by 30 U.S.C. 28f-1, as amended, and 43 CFR 3834 and 3835.

Our records do not show receipt of a maintenance fee payment or small miner waiver filed on or before the due date. Therefore, the claims listed above are forfeit.

### Reclamation Requirements

This decision does not relieve you of the liability for reclamation of all areas disturbed by your activities on lands covered by the subject mining claim(s) and/or site(s). After you complete the reclamation, you must notify the authorized officer of the appropriate surface managing agency so that the authorized officer may conduct a final site inspection and determine whether you may be released from liability. If you fail to reclaim the land to the satisfaction of the authorized officer, the surface management agency may cite you for noncompliance under its surface management regulations. For land administered by the Bureau of Land Management (BLM), if you fail to

reclaim the land to the satisfaction of the authorized officer as required in 43 CFR Subpart 3809, BLM will issue an order of noncompliance under 43 CFR 3809.601(a). If you fail to comply with the non-compliance order, BLM may take further action under 43 CFR 3809.604. Failure to conduct reclamation is a prohibited act that may subject you to criminal penalties. See 43 CFR 3809.605(h) and 43 CFR 3809.700.

### Appeal Procedures

This decision may be appealed to the Interior Board of Land Appeals, Office of the Secretary, in accordance with the regulations contained in 43 CFR, Part 4, and the enclosed Form 1842-1. If an appeal is taken, your notice of appeal must be filed in this office (at the above address) within 30 days from receipt of this decision. The appellant has the burden of showing that the decision appealed from is in error.

If you wish to file a petition pursuant to regulation 43 CFR 4.21 (58 FR 4939, January 19, 1993) for a stay of the effectiveness of this decision during the time that your appeal is being reviewed by the Board, the petition for a stay must accompany your notice of appeal. A petition for a stay is required to show sufficient justification based on the standards listed below. Copies of the notice of appeal and petition for a stay **must** also be submitted to each party named in this decision and to the Interior Board of Land Appeals and to the appropriate Office of the Solicitor (see 43 CFR 4.413) at the same time the original documents are filed with this office. If you request a stay, you have the burden of proof to demonstrate that a stay should be granted.

### Standards for Obtaining a Stay

Except as otherwise provided by law or other pertinent regulation, a petition for a stay of a decision pending appeal shall show sufficient justification based on the following standards:

- (1) The relative harm to the parties if the stay is granted or denied,
- (2) The likelihood of the appellant's success on the merits,
- (3) The likelihood of immediate and irreparable harm if the stay is not granted, and
- (4) Whether the public interest favors granting the stay.

Please include your AMC serial number(s) on all correspondence. If additional information is required, please call RéAnn Myers at 602-417-9413.

*Rebecca Heick*

Rebecca Heick  
Deputy State Director  
Lands, Minerals, and Energy Division

Enclosure

JIM ED COTTLE SR AND LISA CLOPTON  
3478 CATCLAW DR PMB 228  
ABILENE TX 79606-8224

<u>LEAD FILE NUMBER</u>	<u>CLAIM NUMBER</u>	<u>CLAIM NAME</u>
AMC425045	AMC425046	GOLDEN EAGLE #2
AMC425247	AMC425247	BLUE GOLD
AMC425284	AMC425288	LONE HILLS GOLD
AMC425284	AMC425289	MILLSITE CANYONGOLD1
AMC425284	AMC425293	SECRET CANYON #2
AMC425597	AMC425598	GASTON MINE
AMC425919	AMC425929	BBG #11
AMC426116	AMC426117	SILVER PHEASANT
AMC426123	AMC426126	SUGAR LOAF MINE
AMC427520	AMC427526	PERSHING
AMC429608	AMC429610	SUGARBOWL MINE
AMC429642	AMC429644	TELEGRAPH MINE
AMC429994	AMC429994	SHADOW MOUNTAIN

SENDER: COMPLETE THIS SECTION

COMPLETE THIS SECTION ON DELIVERY

- Complete items 1, 2, and 3.
- Print your name and address on the reverse so that we can return the card to you.
- Attach this card to the back of the mailpiece, or on the front if space permits.

1. Article Addressed to:  
 JIM ED COTTLE SR AND LISA CLOPTON  
 3478 CATCLAW DR PMB 228  
 ABILENE TX 79606-8224  
 920/RM/AMC425045/425247/425284/  
 425597/425919/426116/426123/42752  
 0/429608/429642/429994



9590 9402 1825 6104 0397 13

2. Article Number (Transfer from service label)  
 7016 1370 0001 2495 2868

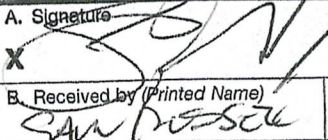
A. Signature   Agent  
 Addressee

B. Received by (Printed Name) Sam Rouse C. Date of Delivery 10/14/16

D. Is delivery address different from item 1?  Yes  
 If YES, enter delivery address below:  No

3. Service Type

<input type="checkbox"/> Adult Signature	<input type="checkbox"/> Priority Mail Express®
<input type="checkbox"/> Adult Signature Restricted Delivery	<input type="checkbox"/> Registered Mail™
<input checked="" type="checkbox"/> Certified Mail®	<input type="checkbox"/> Registered Mail Restricted Delivery
<input type="checkbox"/> Certified Mail Restricted Delivery	<input type="checkbox"/> Return Receipt for Merchandise
<input type="checkbox"/> Collect on Delivery	<input checked="" type="checkbox"/> Signature Confirmation™
<input type="checkbox"/> Collect on Delivery Restricted Delivery	<input type="checkbox"/> Signature Confirmation Restricted Delivery
<input type="checkbox"/> Mail Restricted Delivery	

PS Form 3811, July 2015 PSN 7530-02-000-9053

Domestic Return Receipt

USPS TRACKING#



9590 9402 1825 6104 0397 13

First-Class Mail  
 Postage & Fees Paid  
 USPS  
 Permit No. G-10

United States Postal Service

RECEIVED  
 BLM AZ  
 2016 OCT 18 PM  
 PHOENIX, AZ

• Sender: Please print your name, address, and ZIP+4® in this box•

UNITED STATES  
 DEPARTMENT OF THE INTERIOR  
 Bureau of Land Management  
 Arizona State Office  
 One N. Central Avenue, Suite 800  
 Phoenix, AZ 85004-4427

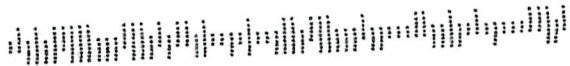



USPS TRACKING #

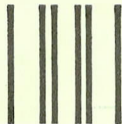

First-Class Mail  
Postage & Fees Paid  
USPS  
Permit No. G-10

9590 9402 1212 5246 1568 61

**United States  
Postal Service**

• Sender: Please print your name, address, and ZIP+4® in this box•

UNITED STATES  
DEPARTMENT OF THE INTERIOR  
Bureau of Land Management  
Arizona State Office  
One N. Central Avenue, Suite 800  
Phoenix, AZ 85004-4427

4442700

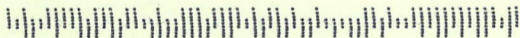

**SENDER: COMPLETE THIS SECTION**

- Complete items 1, 2, and 3.
- Print your name and address on the reverse so that we can return the card to you.
- Attach this card to the back of the mailpiece, or on the front if space permits.

1. Article Addressed to:

ROBERT LANE  
 ARACELY LANE  
 1367 RIVERPORT RD  
 SCRANTON, AR 72863-8932  
 920/RE/AMC426123



9590 9402 1212 5246 1568 61

2. Article Number (Transfer from service label)

7015 1520 0001 7910 5145

**COMPLETE THIS SECTION ON DELIVERY**

A. Signature

X *Aracely Lane*

Agent

Addressee

B. Received by (Printed Name)

*Aracely Lane*

C. Date of Delivery

*1-20-16*

D. Is delivery address different from item 1?

Yes

If YES, enter delivery address below:

NO

2016 JAN 25 P 2:31

PHOENIX, ARIZONA

3. Service Type

- Adult Signature
- Adult Signature Restricted Delivery
- Certified Mail®
- Certified Mail Restricted Delivery
- Collect on Delivery
- Collect on Delivery Restricted Delivery
- Insured Mail

- Priority Mail Express®
- Registered Mail™
- Registered Mail Restricted Delivery
- Return Receipt for Merchandise
- Signature Confirmation™
- Signature Confirmation Restricted Delivery

Mail Restricted Delivery (0)



# United States Department of the Interior



BUREAU OF LAND MANAGEMENT  
Arizona State Office  
One North Central Avenue, Suite 800  
Phoenix, Arizona 85004-4427  
www.blm.gov/az/

JAN 13 2016

In Reply Refer To:  
3800 (9200) RE  
AMC426123

CERTIFIED MAIL - RETURN RECEIPT REQUESTED No. 7015 1520 0001 7910 5145

## DECISION

ROBERT LANE  
ARACELY LANE : This decision affects those claims shown  
1367 RIVERPORT RD : in the block below.  
SCRANTON, AR 72863-8932 :

---

AMC426123  
HUMBOLDT

---

### MINING CLAIMS DECLARED FORFEIT

The mining claims listed above have been declared forfeit as of September 1, 2015, for failure to timely file the required maintenance fee payment or small miner's maintenance fee waiver (waiver).

Claimants are required to pay an annual non-refundable maintenance fee of \$155 per 20 acres or portion thereof, or submit a waiver, on or before September 1 of each year. These requirements were established by 30 U.S.C. 28f-1, as amended, and 43 CFR 3834 and 3835.

Our records do not show receipt of a maintenance fee payment or small miner waiver filed on or before the due date. Therefore, the claims listed above are forfeit.

### Reclamation Requirements

This decision does not relieve you of the liability for reclamation of all areas disturbed by your activities on lands covered by the subject mining claim(s) and/or site(s). After you complete the reclamation, you must notify the authorized officer of the appropriate surface managing agency so that the authorized officer may conduct a final site inspection and determine whether you may be released from liability. If you fail to reclaim the land to the satisfaction of the authorized officer, the surface management agency may cite you for noncompliance under its surface management regulations. For land administered by the Bureau of Land Management (BLM), if you fail to

reclaim the land to the satisfaction of the authorized officer as required in 43 CFR Subpart 3809, BLM will issue an order of noncompliance under 43 CFR 3809.601(a). If you fail to comply with the non-compliance order, BLM may take further action under 43 CFR 3809.604. Failure to conduct reclamation is a prohibited act that may subject you to criminal penalties. See 43 CFR 3809.605(h) and 43 CFR 3809.700.

### Appeal Procedures

This decision may be appealed to the Interior Board of Land Appeals, Office of the Secretary, in accordance with the regulations contained in 43 CFR, Part 4, and the enclosed Form 1842-1. If an appeal is taken, your notice of appeal must be filed in this office (at the above address) within 30 days from receipt of this decision. The appellant has the burden of showing that the decision appealed from is in error.

If you wish to file a petition pursuant to regulation 43 CFR 4.21 (58 FR 4939, January 19, 1993) for a stay of the effectiveness of this decision during the time that your appeal is being reviewed by the Board, the petition for a stay must accompany your notice of appeal. A petition for a stay is required to show sufficient justification based on the standards listed below. Copies of the notice of appeal and petition for a stay **must** also be submitted to each party named in this decision and to the Interior Board of Land Appeals and to the appropriate Office of the Solicitor (see 43 CFR 4.413) at the same time the original documents are filed with this office. If you request a stay, you have the burden of proof to demonstrate that a stay should be granted.

### Standards for Obtaining a Stay

Except as otherwise provided by law or other pertinent regulation, a petition for a stay of a decision pending appeal shall show sufficient justification based on the following standards:

- (1) The relative harm to the parties if the stay is granted or denied,
- (2) The likelihood of the appellant's success on the merits,
- (3) The likelihood of immediate and irreparable harm if the stay is not granted, and
- (4) Whether the public interest favors granting the stay.

Please include your AMC serial number(s) on all correspondence. If additional information is required, please call Rod Ebert at 602-417-9397.

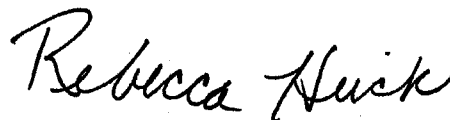

Rebecca Heick  
Deputy State Director  
Lands, Minerals and Energy Division

Enclosure(s)

**NOTICE!!**

**These documents have been scanned!**

**Do not place un-scanned documents beneath this notice!**

**Do not remove this notice from this file!**

GPO Jacket No. 560-102  
Print Order 61540  
Rise Business Services, LLC  
Job=AZ15 5/10/2019



Box Number= AZ15035



Claim Begin-End: AMC426123-AMC426126

3 Transfers



AZ15035-15

AMC425596-AMC426147

RECORDING REQUESTED BY:  
(MAIL RECORDING TO)

Robert & Aracely Lane  
1367 Riverport Rd.  
Scranton, AR 72863

FOR RECORDERS ONLY

**UNPATENTED MINING CLAIM QUITCLAIM DEED**

**NOTICE IS HEREBY GIVEN** that, Jeremiah's International Trading Company, whose current mailing address is, 289 34<sup>th</sup> St. N. St. Petersburg, FL. 33713, (collectively, "GRANTOR"), in consideration of money received and other good and valuable consideration, do hereby remise, release and forever quitclaim to;

Robert E Lane and Aracely Lane (married), whose mailing address is 1367 Riverport Rd Scranton, AR 72863, (collectively, "Grantee"), all rights, title and interest of Grantor, in and to the following mining claim: Humboldt, a lode mining claim, serial number AMC426123.

The general course of this claim is North and South and is situated in the Gila Salt River Meridian, La Paz County, Arizona. This claim encompasses portions of the following legal subdivisions; SW 4 of NE 1/4 and NE 1/4 of SE 1/4 of Section 21, Township 7 North, Range 16 West. This claim is 600 feet in length and 1500 feet in width.

IN WITNESS, this Mining Claim Quitclaim Deed is executed this 2<sup>nd</sup> day of July, 2014

Signature(s) of Grantor(s): [Signature]  
Authorized Officer for Jeremiah's International Trading Company

STATE OF FLORIDA  
COUNTY OF PINELLAS:

On the 2<sup>nd</sup> day of July, 2014, Heaven McAvery did personally appear before me, who proved to me on the basis of satisfactory evidence to be the person(s) whose name(s) is/are subscribed to the within instrument and acknowledged to me that he/she/they executed the same in his/her/their authorized capacity(ies), and that but his/her/their signature(s) on the instrument the person(s), or the entity upon behalf of which the person(s) acted, executed the instrument.

[Signature]  
Notary Public, Pinellas County, Florida  
My Commission expires on: 7/28/15

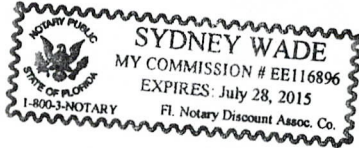

Document Prepared by:  
Jeremiah's International Trading Company  
289 34<sup>th</sup> Street North  
St. Petersburg, Fl. 33713



RECEIVED  
PLM AND RECORDS OFFICE  
2014 JUL - 7 P 3: 08  
PHOENIX, ARIZONA

Brandy Hartman  
289 34th St N.  
St Pete FL 33713

TAMPA FL 335  
SAINT PETERSBURG FL  
03 JUL 2014 PM 4 L



RECEIVED  
BLM AZ STATE OFFICE

2014 JUL -7 P 3:02

PHOENIX, ARIZONA

Arizona BLM  
One N. Central Ave  
Suite #800  
Phoenix AZ. 85004-4427

85004442700



**United States Department of the Interior**  
**Bureau of Land Management**  
 LANDS/RECREATION & PLANNING  
 ONE N CENTRAL AVE  
 PHOENIX, AZ 85004 -2203  
 Phone: 602-417-9200

Receipt

No: 3072527

<b>Transaction #:</b> 3163653	
<b>Date of Transaction:</b> 07/08/2014	
CUSTOMER:	
JEREMIAHS INTERNATIONAL TRADING CO INC 289 34TH ST N ST PETERSBURG, FL 33713-8514 US	

LINE #	QTY	DESCRIPTION	REMARKS	UNIT PRICE	TOTAL
1	1.00	LOCATABLE MINERALS / MINING CLAIMS- NOT NEW-UNADJUD, ONE AUTH NO. ONLY / MINING CLAIM MONEY RECEIVED CASES: AMC426123/\$20.00	QCD - 2	- n/a -	20.00
<b>TOTAL:</b>					<b>\$20.00</b>

PAYMENT INFORMATION					
1	AMOUNT:	20.00	POSTMARKED:	07/03/2014	
	TYPE:	CHECK	RECEIVED:	07/07/2014	
	CHECK NO:	105722			
	NAME:	JEREMIAHS INTERNATIONAL 289 34TH ST N ST PETERSBURG FL 33713-8514 US			

REMARKS

This receipt was generated by the automated BLM Collections and Billing System and is a paper representation of a portion of the official electronic record contained therein.





AMC 426123  
DEPARTMENT OF LAND TRANSFER INFORMATION  
PROTECTING AMERICA'S RESOURCES

STEVEN L. CYROS  
SUPERVISORY FIELD AGENT

942 CALLE AMANECER  
BLDG. B / MS 548  
SAN CLEMENTE, CA 92673  
TEL (949) 366-9484  
FAX (949) 366-9945  
SCYROS@DLTI.US.COM  
WWW.LANDTRANSFER.US.COM

April 28, 2014

Bureau of Land Management  
Arizona State Office  
One Central Avenue  
Suite 800  
Phoenix, AZ 85004-4427

RE: Mining Claim Change of Ownership/Quitclaim Deed to be processed

To Whom It May Concern:

Enclosed, please find a Mining Claim Change of Ownership Request in the form of Legal Quitclaim Deed (Notarized) to be processed.

Also attached you will find my check for payment in the amount of \$10.00 for the processing of this Quitclaim Deed. This has already been recorded at the County Arizona Recorders Office as required.

You can either return this to me, and I will distribute it to the respective owner, or you can mail it to the individual whose name and address is indicated on the top of the document - whichever you prefer.

Should you need any additional information, please do not hesitate to call on me.

Warmest Regards,

Tina Bush  
949.366.9484

PHOENIX, ARIZONA

2014 MAY - 1 P 2: 51

RECEIVED  
BLM AZ STATE OFFICE

ENTERED  
MAY 05 2014  
BY: *fm*

RECORDING REQUESTED BY:

(Mail recording to;)

John Drumm  
PO Box 616  
Coshocton, OH  
43812

FOR RECORDER'S USE

**UNPATENTED MINING CLAIM QUITCLAIM DEED**

**NOTICE IS HEREBY GIVEN** that Department of Land Transfer Information, Inc., a Wyoming Corporation whose current mailing address is 942 Calle Amanecer, Suite B, San Clemente, CA 92673 (collectively, "GRANTOR"), in consideration of money received and other good and valuable consideration, do hereby remise, release and forever quitclaim to;

John Drumm, whose mailing address is PO Box 616 Coshocton, OH 43812 (collectively, "Grantee"), all rights, title and interest of Grantor, in and to the following mining claim; The **LUCKY SEVEN DOWN** lode mining claim, **AMC426124**.

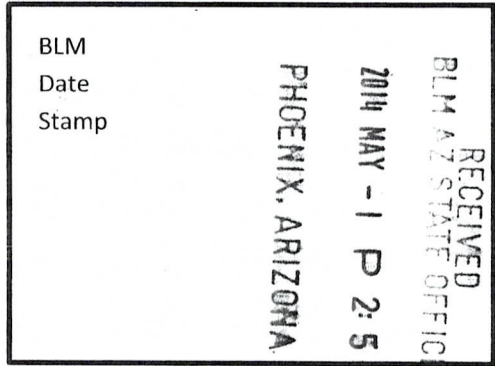

The general course of this claim is North and South and it is situated in the Gila Salt River Meridian, La Paz County, Arizona. This claim is 600 feet in length and 1,500 feet in width. This claim runs from the location monument on which this location notice is posted approximately 1,200 feet in a Northerly direction to the North end line and approximately 300 feet in a Southerly direction to the South end line. This claim is marked by four (4) monuments, one at each corner of the claim. Additionally, there are two (2) end-line markers on each side of the center of the claim. All markers are 4" x 4" wooden posts that are buried 1.5' in the ground and protrude 4.5' above the ground embossed with the name of the claim and its location in relation to the claim. The location monument on which this notice is posted is situated within Section 13, Township 7N, Range 13W, Gila Salt River Meridian, La Paz County Arizona and this claim encompasses portions of the following quarter section (s), Township (s) and Range (s); NE 1/4 of NE 1/4 and SE 1/4 of NE 1/4 of Section 14, T7N, R13W and NW 1/4 of NW 1/4 and SW 1/4 of NW 1/4 of Section 13, T7N, R13W, Gila Salt River Meridian, La Paz County Arizona. The locality of this claim with reference to some natural object or permanent monument and additional information (if any) concerning its locality are as follows: NW corner of this claim is 360 Feet South and 120 Feet West of the NW corner of Section 13, T7N, R13W.

IN WITNESS WHEREOF, this Mining Claim Quitclaim Deed is executed on April 22, 2014:

**DEPARTMENT OF LAND TRANSFER INFORMATION, INC.**

  
Steven L. Cyros, President

Authorized Officer for DEPARTMENT OF LAND TRANSFER INFORMATION, INC.

STATE OF CALIFORNIA  
COUNTY OF ORANGE, SS:

On April 22, 2014 before me, James Pak, Notary Public, personally appeared

Steven L. Cyros who proved to me on the basis of satisfactory evidence to be the person(s) whose names(s) is/are subscribed to the within instrument and acknowledged to me that he/she/they executed the same in his/her/their authorized capacity (ies), and that but his/her/their signatures(s) on the instrument the person(s), or the entity upon behalf of which the person(s) acted, executed the instrument.

WITNESS my hand and notarial seal.

  
Signature of officer

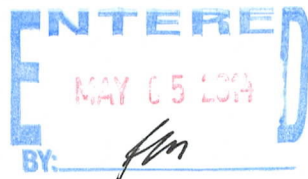
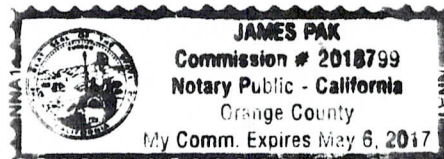

RECORDING REQUESTED BY:

(Mail recording to;)

John Drumm  
PO Box 616  
Coshocton, OH  
43812

FOR RECORDER'S USE

**UNPATENTED MINING CLAIM QUITCLAIM DEED**

**NOTICE IS HEREBY GIVEN** that Department of Land Transfer Information, Inc., a Wyoming Corporation whose current mailing address is 942 Calle Amanecer, Suite B, San Clemente, CA 92673 (collectively, "GRANTOR"), in consideration of money received and other good and valuable consideration, do hereby remise, release and forever quitclaim to;

John Drumm, whose mailing address is PO Box 616 Coshocton, OH 43812 (collectively, "Grantee"), all rights, title and interest of Grantor, in and to the following mining claim; The **LUCKY SEVEN UP** lode mining claim, **AMC426125**.

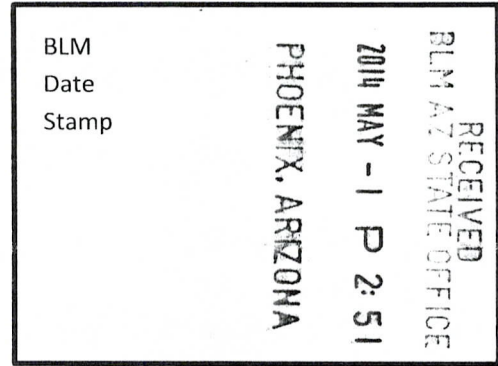

The general course of this claim is North and South and it is situated in the Gila Salt River Meridian, La Paz County, Arizona. This claim is 600 feet in length and 1,500 feet in width. This claim runs from the location monument on which this location notice is posted approximately 1,200 feet in a Northerly direction to the North end line and approximately 300 feet in a Southerly direction to the South end line. This claim is marked by four (4) monuments, one at each corner of the claim. Additionally, there are two (2) end-line markers on each side of the center of the claim. All markers are 4" x 4" wooden posts that are buried 1.5' in the ground and protrude 4.5' above the ground embossed with the name of the claim and its location in relation to the claim. The location monument on which this notice is posted is situated within Section 12, Township 7N, Range 13W, Gila Salt River Meridian, La Paz County Arizona and this claim encompasses portions of the following quarter section (s), Township (s) and Range (s); SW 1/4 of SW 1/4 of Section 12, T7N, R13W and NW 1/4 of NW 1/4 of Section 13, T7N, R13W, Gila Salt River Meridian, La Paz County Arizona. The locality of this claim with reference to some natural object or permanent monument and additional information (if any) concerning its locality are as follows: SW corner of this claim is 360 Feet South and 0 Feet East of the SW corner of Section 12, T7N, R13W.

IN WITNESS WHEREOF, this Mining Claim Quitclaim Deed is executed on April 22, 2014:

**DEPARTMENT OF LAND TRANSFER INFORMATION, INC.**



Steven L. Cyros, President  
Authorized Officer for DEPARTMENT OF LAND TRANSFER INFORMATION, INC.

STATE OF CALIFORNIA  
COUNTY OF ORANGE, SS:

On April 22, 2014 before me, James Pak, Notary Public personally appeared

Steven L. Cyros who proved to me on the basis of satisfactory evidence to be the person(s) whose names(s) is/are subscribed to the within instrument and acknowledged to me that he/she/they executed the same in his/her/their authorized capacity(ies), and that but his/her/their signatures(s) on the instrument the person(s), or the entity upon behalf of which the person(s) acted, executed the instrument.

WITNESS my hand and notarial seal.

  
Signature of officer

**ENTERED**  
MAY 05 2014  
RM

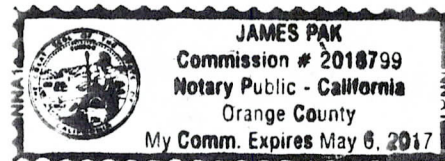



**Department of Land Transfer**

942 Calle Amanecer  
Bldg. B / MS 548  
San Clemente, CA 92673

RECEIVED  
BLM AZ STATE OFFICE

2014 MAY -1 P 2:45

PHOENIX, ARIZONA



Bureau of Land Management  
Arizona State Office  
One Central Avenue  
Suite 800  
Phoenix, AZ 85004-4427

8500484427 0041



Department of Land Transfer  
942 Calle Amanecer  
Bldg. B / MS 548  
San Clemente, CA 92673

**United States Department of the Interior  
Bureau of Land Management  
LANDS/RECREATION & PLANNING  
ONE N CENTRAL AVE  
PHOENIX, AZ 85004 -2203  
Phone: 602-417-9200**

Receipt

No: 3023553

<b>Transaction #:</b> 3113786	
<b>Date of Transaction:</b> 05/02/2014	
<b>CUSTOMER:</b>	
DEPARTMENT OF LAND TRANSFER INFORMATION INC 942 CALLE AMANECER STE B SAN CLEMENTE, CA 92673-6220 US	

LINE #	QTY	DESCRIPTION	REMARKS	UNIT PRICE	TOTAL
1	1.00	LOCATABLE MINERALS / MINING CLAIMS- NOT NEW-UNADJUD, ONE AUTH NO. ONLY / MINING CLAIM MONEY RECEIVED <b>CASES: AMC426124/\$20.00</b>	QCD - 2	- n/a -	20.00
<b>TOTAL:</b>					<b>\$20.00</b>

PAYMENT INFORMATION					
1	AMOUNT:	10.00	POSTMARKED:	04/28/2014	
	TYPE:	CHECK	RECEIVED:	05/01/2014	
	CHECK NO:	5262			
	NAME:	DEPARTMENT OF LAND TRANSFER INFORMATION 942 CALLE AMANECER STE B SAN CLEMENTE CA 92673-6220 US			
2	AMOUNT:	10.00	POSTMARKED:	04/28/2014	
	TYPE:	CHECK	RECEIVED:	05/01/2014	
	CHECK NO:	5263			
	NAME:	DEPARTMENT OF LAND TRANSFER INFORMATION 942 CALLE AMANECER STE B SAN CLEMENTE CA 92673-6220 US			

<b>REMARKS</b>

This receipt was generated by the automated BLM Collections and Billing System and is a paper representation of a portion of the official electronic record contained therein.



# DEPARTMENT OF LAND TRANSFER INFORMATION

PROTECTING AMERICA'S RESOURCES

AMC 426123

STEVEN L. CYROS  
SUPERVISORY FIELD AGENT

942 CALLE AMANECER  
BLDG. B / MS 548  
SAN CLEMENTE, CA 92673  
TEL (949) 366-9484  
FAX (949) 366-9945  
SCYROS@DLTI.US.COM  
WWW.LANDTRANSFER.US.COM

March 5, 2013

Bureau of Land Management  
Arizona State Office  
One Central Avenue  
Suite 800  
Phoenix, AZ 85004-4427

RE: Mining Claim Change of Ownership/Quitclaim Deed to be processed

To Whom It May Concern:

Enclosed, please find a Mining Claim Change of Ownership Request in the form of Legal Quitclaim Deed (Notarized) to be processed.

Also attached you will find my check for payment in the amount of \$10.00 for the processing of this Quitclaim Deed. This has already been recorded at the Maricopa County Arizona Recorders Office as required.

You can either return this to me, and I will distribute it to the respective owner, or you can mail it to the individual whose name and address is indicated on the top of the document - whichever you prefer.

Should you need any additional information, please do not hesitate to call on me.

Warmest Regards,

Steven L. Cyros

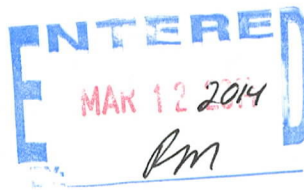

PHOENIX, ARIZONA

2014 MAR - 7 P 3:14

RECEIVED  
BLM AZ STATE OFFICE

RECORDING REQUESTED BY:

(Mail recording to;)

Jeremiah's International Trading Co

289 34<sup>th</sup> St. N

Saint Petersburg, FL

33713

FOR RECORDER'S USE

**UNPATENTED MINING CLAIM QUITCLAIM DEED**

**NOTICE IS HEREBY GIVEN** that Department of Land Transfer Information, Inc., a Wyoming Corporation whose current mailing address is 942 Calle Amanecer, Suite B, San Clemente, CA 92673 (collectively, "GRANTOR"), in consideration of money received and other good and valuable consideration, do hereby remise, release and forever quitclaim to;

Jeremiah's International Trading Co, whose mailing address is 289 34<sup>th</sup> St. N, Saint Petersburg, FL 33713 (collectively, "Grantee"), all rights, title and interest of Grantor, in and to the following mining claim; The **HUMBOLDT** lode mining claim, **AMC426123**.

The general course of this claim is North and South and it is situated in the Gila Salt River Meridian, La Paz County, Arizona.

This claim is 600 feet in length and 1,500 feet in width. This claim runs from the location monument on which this location notice is posted approximately 1,200 feet in a Northerly direction to the North end line and approximately 300 feet in a Southerly direction to the South end line.

This claim is marked by four (4) monuments, one at each corner of the claim. Additionally, there are two (2) end-line markers on each side of the center of the claim. All markers are 4" x 4" wooden posts that are buried 1.5' in the ground and protrude 4.5' above the ground embossed with the name of the claim and its location in relation to the claim.

The location monument on which this notice is posted is situated within Section 21, Township 7N, Range 16W, Gila Salt River Meridian, La Paz County Arizona and this claim encompasses portions of the following quarter section (s), Township (s) and Range (s); SW 1/4 of NE 1/4 and NW 1/4 of SE 1/4 of Section 21, T7N, R16W, Gila Salt River Meridian, La Paz County Arizona.

The locality of this claim with reference to some natural object or permanent monument and additional information (if any) concerning its locality are as follows: SE corner of this claim is 470 Feet North and 0 Feet West of the SE corner of NW 1/4 of SE 1/4 Section 21, T7N, R16W.

IN WITNESS WHEREOF, this Mining Claim Quitclaim Deed is executed on February 24, 2014:

**DEPARTMENT OF LAND TRANSFER INFORMATION, INC.**

Steven L. Cyros, President

Authorized Officer for DEPARTMENT OF LAND TRANSFER INFORMATION, INC.

STATE OF CALIFORNIA  
COUNTY OF ORANGE, SS:

I, Brad Meindertma, a Notary Public in and for said County and State, hereby certify that Steven L. Cyros, personally appeared before me this day and acknowledged execution of the foregoing as his/her free and voluntary act and deed.

WITNESS my hand and notarial seal this 24 day of February, 2014.

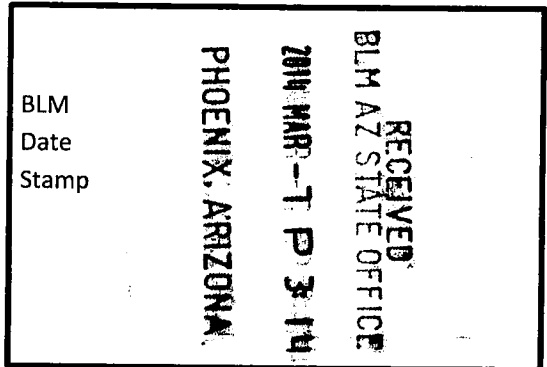
  
Notary Public



**Steven L. Cyros**

942 Calle Amanecer  
Bldg. B / MS 548  
San Clemente, CA 92673

SANTA ANA CA 926

05 MAR 2014 PM 4 L



RECEIVED  
BLM AZ STATE OFFICE

2014 MAR - 7 P 3:03

PHOENIX, ARIZONA

Bureau of Land Management  
Arizona State Office  
One North Central Ave., Suite 800  
Phoenix, AZ 85004-4427

85004442700



Steven L. Cyros  
942 Calle Amanecer  
Bldg. B / MS 548  
San Clemente, CA 92673



**United States Department of the Interior  
Bureau of Land Management  
LANDS/RECREATION & PLANNING  
ONE N CENTRAL AVE  
PHOENIX, AZ 85004 -2203  
Phone: 602-417-9200**

Receipt

No: 2985353

<b>Transaction #:</b> 3074323	
<b>Date of Transaction:</b> 03/10/2014	
<b>CUSTOMER:</b>	
DEPARTMENT OF LAND TRANSFER INFORMATION INC 942 CALLE AMANECER BLDG B548 SAN CLEMENTE, CA 92673-6220 US	

LINE #	QTY	DESCRIPTION	REMARKS	UNIT PRICE	TOTAL
1	1.00	LOCATABLE MINERALS / MINING CLAIMS- NOT NEW-UNADJUD, ONE AUTH NO. ONLY / MINING CLAIM MONEY RECEIVED <b>CASES: AMC426123/\$10.00</b>	QCD -1	- n/a -	10.00
<b>TOTAL:</b>					<b>\$10.00</b>

PAYMENT INFORMATION					
1	AMOUNT:	10.00	POSTMARKED:	03/05/2014	
	TYPE:	CHECK	RECEIVED:	03/07/2014	
	CHECK NO:	5071			
	NAME:	DEPARTMENT OF LAND TRANSFER INFORMATION 942 CALLE AMANECER BLDG B548 SAN CLEMENTE CA 92673-6220 US			

REMARKS

This receipt was generated by the automated BLM Collections and Billing System and is a paper representation of a portion of the official electronic record contained therein.



DEPARTMENT OF LAND TRANSFER INFORMATION  
PROTECTING AMERICA'S RESOURCES

STEVEN L. CYROS  
SUPERVISORY FIELD AGENT

942 CALLE AMANECER  
BLDG. B / MS 548  
SAN CLEMENTE, CA 92673  
TEL (949) 366-9484  
FAX (949) 366-9945  
SCYROS@DLTI.US.COM  
WWW.LANDTRANSFER.US.COM

January 30, 2014

Bureau of Land Management  
Arizona State Office  
One Central Avenue  
Suite 800  
Phoenix, AZ 85004-4427

AMC 426123

RE: Mining Claim Change of Ownership/Quitclaim Deed to be processed

To Whom It May Concern:

Enclosed, please find a Mining Claim Change of Ownership Request in the form of Legal Quitclaim Deed (Notarized) to be processed.

Also attached you will find my check for payment in the amount of \$10.00 for the processing of this Quitclaim Deed. This has already been recorded at the La Paz County Arizona Records Office as required.

You can either return this to me, and I will distribute it to the respective owner, or you can mail it to the individual whose name and address is indicated on the top of the document – whichever you prefer.

Should you need any additional information, please do not hesitate to call on me.

Warmest Regards,

Steven L. Cyros

RECEIVED  
BLM AZ STATE OFFICE  
2014 FEB - 7 P 2:59  
PHOENIX, ARIZONA

ENTERED  
FEB 19 2014  
BY: DM

RECORDING REQUESTED BY:  
(Mail recording to;)  
Jim Ed Cottle, Sr.  
201 Ward St  
Moran, Tx  
76464

FOR RECORDER'S USE

**UNPATENTED MINING CLAIM QUITCLAIM DEED**

**NOTICE IS HEREBY GIVEN** that Department of Land Transfer Information, Inc., a Wyoming Corporation whose current mailing address is 942 Calle Amanecer, Suite B, San Clemente, CA 92673 (collectively, "GRANTOR"), in consideration of money received and other good and valuable consideration, do hereby remise, release and forever quitclaim to;

Jim Ed Cottle, Sr., whose mailing address is 201 Ward St, Moran, Tx 76464 (collectively, "Grantee"), all rights, title and interest of Grantor, in and to the following mining claim; The **SUGAR LOAF MINE** lode mining claim, **AMC426126**.

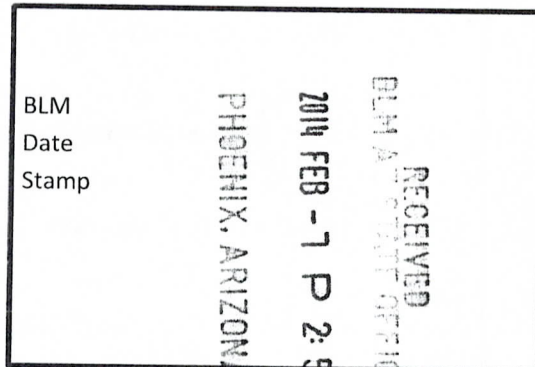

The general course of this claim is East and West and it is situated in the Gila Salt River Meridian, La Paz County, Arizona.

This claim is 1,500 feet in length and 600 feet in width. This claim runs from the location monument on which this location notice is posted approximately 1,200 feet in an Easterly direction to the East end line and approximately 300 feet in a Southerly direction to the South end line.

This claim is marked by four (4) monuments, one at each corner of the claim. Additionally, there are two (2) end-line markers on each side of the center of the claim. All markers are 4" x 4" wooden posts that are buried 1.5' in the ground and protrude 4.5' above the ground embossed with the name of the claim and its location in relation to the claim.

The location monument on which this notice is posted is situated within Section 16, Township 7N, Range 16W, Gila Salt River Meridian, La Paz County Arizona and this claim encompasses portions of the following quarter section (s), Township (s) and Range (s); SE 1/4 of SE 1/4 and SW 1/4 of SE 1/4 of Section 16, T7N, R16W, Gila Salt River Meridian, La Paz County Arizona.

The locality of this claim with reference to some natural object or permanent monument and additional information (if any) concerning its locality are as follows: SE corner of this claim is 570 Feet North and 0 Feet West of the SE corner of Section 16, T7N, R16W.

IN WITNESS WHEREOF, this Mining Claim Quitclaim Deed is executed on January 30, 2014:

**DEPARTMENT OF LAND TRANSFER INFORMATION, INC.**

Steven L. Cyros, President  
Authorized Officer for DEPARTMENT OF LAND TRANSFER INFORMATION, INC.

STATE OF CALIFORNIA  
COUNTY OF ORANGE, SS:

I, Brad Meinderttsma, a Notary Public in and for said County and State, hereby certify that Steven L. Cyros, personally appeared before me this day and acknowledged execution of the foregoing as his/her free and voluntary act and deed.

WITNESS my hand and notarial seal this 30 day of January, 2014.

  
Notary Public



**Steven L. Cyros**

942 Calle Amanecer  
Bldg. B / MS 548  
San Clemente, CA 92673

SANTA ANA CA 926

RECEIVED  
BLM AZ STATE OFFICE

05 FEB 2014 PM 10 L



2014 FEB -7 PM 2: 14

PHOENIX, ARIZONA

Bureau of Land Management  
Arizona State Office  
One Central Avenue  
Suite 800  
Phoenix, AZ 85004-4427

85004442700



Steven L. Cyros  
942 Calle Amanecer  
Bldg. B / MS 548  
San Clemente, CA 92673

**United States Department of the Interior**  
**Bureau of Land Management**  
 LANDS/RECREATION & PLANNING  
 ONE N CENTRAL AVE  
 PHOENIX, AZ 85004 -2203  
 Phone: 602-417-9200

Receipt

No: 2964929

<b>Transaction #:</b> 3053030	
<b>Date of Transaction:</b> 02/10/2014	
CUSTOMER:	
DEPARTMENT OF LAND TRANSFER INFORMATION INC 942 CALLE AMANECER BLDG B548 SAN CLEMENTE, CA 92673-6220 US	

LINE #	QTY	DESCRIPTION	REMARKS	UNIT PRICE	TOTAL
1	1.00	LOCATABLE MINERALS / MINING CLAIMS- NOT NEW-UNADJUD, ONE AUTH NO. ONLY / MINING CLAIM MONEY RECEIVED <b>CASES: AMC426126/\$10.00</b>	QCD - 1	- n/a -	10.00
<b>TOTAL:</b>					<b>\$10.00</b>

PAYMENT INFORMATION					
1	AMOUNT:	10.00	POSTMARKED:	02/05/2014	
	TYPE:	CHECK	RECEIVED:	02/07/2014	
	CHECK NO:	5040			
	NAME:	DEPARTMENT OF LAND TRANSFER INFORMATION 942 CALLE AMANECER BLDG B548 SAN CLEMENTE CA 92673-6220 US			

REMARKS

This receipt was generated by the automated BLM Collections and Billing System and is a paper representation of a portion of the official electronic record contained therein.

**NOTICE!!**

**These documents have been scanned!**

**Do not place un-scanned documents beneath this notice!**

**Do not remove this notice from this file!**

GPO Jacket No. 560-102  
Print Order 61540  
Rise Business Services, LLC  
Job=AZ15 5/10/2019



Box Number= AZ15035



Claim Begin-End: AMC426123-AMC426126

4 Miscellaneous



AZ15035-15

AMC425596-AMC426147

**NO  
DOCUMENTS  
FOUND**

NO DOCUMENTS FOUND  
NO DOCUMENTS FOUND

**NOTICE!!**

**These documents have been scanned!**

**Do not place un-scanned documents beneath this notice!**

**Do not remove this notice from this file!**

GPO Jacket No. 560-102  
Print Order 61540  
Rise Business Services, LLC  
Job=AZ15 5/10/2019



Box Number= AZ15035



Claim Begin-End: AMC426123-AMC426126

5 Annual Filings



AZ15035-15

AMC425596-AMC426147



DEPARTMENT OF THE INTERIOR  
BUREAU OF LAND MANAGEMENT  
MINING CLAIMS

Run Date/Time: 9/11/2018

MC Maintenance Fees Paid Through the BLM Pay Portal  
(by Date Paid)

Page 288 Of 723

**CBS Receipt: 4246748**

Printed For Lead File # AMC426123

Agency Tracking ID: 1535379014

Assessment Year: 2019

Number of BLM Serial Nr: 2

Paid On: 8/27/2018

Total Amount Paid: \$310.00

Claim Name	BLM Serial No	Lead File No	Amount Paid
LUCKY SEVEN DOWN	AMC426124	AMC426123	\$155.00
LUCKY SEVEN UP	AMC426125	AMC426123	\$155.00

**United States Department of the Interior**

**Bureau of Land Management**

BUSINESS & SUPPORT SVCS DIV  
 ONE N CENTRAL AVE SUITE 800  
 PHOENIX, AZ 85004 -4427  
 Phone: 602-417-9200

Receipt

No: 4246748

<b>Transaction #:</b> 4362211	
<b>Date of Transaction:</b> 08/27/2018	
CUSTOMER:	
KITTY DRUMM PO BOX 616 COSHOCTON,OH 43812 US	

LINE #	QTY	DESCRIPTION	REMARKS	UNIT PRICE	TOTAL
1	1.00	LOCATABLE MINERALS / MINING CLAIMS-NOT NEW-UNADJUD,ONE AUTH NO. ONLY / MINING CLAIM MONEY RECEIVED <b>CASES: AMC426124/\$310.00</b>		- n/a -	310.00
<b>TOTAL:</b>					<b>\$310.00</b>

PAYMENT INFORMATION				
NOTE: Items will appear on credit card statement as "BLM O Mining Claim".				
1	AMOUNT:	310.00	POSTMARKED:	N/A
	TYPE:	CREDIT CARD	RECEIVED:	08/27/2018
	NAME:	KITTY DRUMM PO BOX 616 COSHOCTON OH 43812 US		
	CARD NO:	XXXXXXXXXXXX0015	AUTH CODE:	071310
	NAME ON CARD:	KITTY DRUMM		
	SIGNATURE:			

REMARKS

This receipt was generated by the automated BLM Collections and Billing System and is a paper representation of a portion of the official electronic record contained therein.

Run Date: 09/05/17

Run Time: 02:33 PM

**DEPARTMENT OF THE INTERIOR  
BUREAU OF LAND MANAGEMENT  
MINING CLAIMS**

**MC Maintenance Fees Paid Through the BLM Pay Portal**

**CBS Receipt: 3963905**

Printed For Lead File # AMC426123

Agency Tracking ID: 1503952581

Assessment Year: 2018

Number of BLM Serial Nr: 2

Paid On: 08/28/2017

Total Amount Paid: \$310.00

Claim Name	BLM Serial No	Lead File No	Amount Paid
LUCKY SEVEN DOWN	AMC426124	AMC426123	\$155.00
LUCKY SEVEN UP	AMC426125	AMC426123	\$155.00

**United States Department of the Interior**  
**Bureau of Land Management**  
 BUSINESS & SUPPORT SVCS DIV  
 ONE N CENTRAL AVE SUITE 800  
 PHOENIX, AZ 85004 -4427  
 Phone: 602-417-9200

Receipt

No: 3963905

<b>Transaction #:</b> 4073778	
<b>Date of Transaction:</b> 08/28/2017	
CUSTOMER:	
	KITTY DRUMM PO BOX 616 COSHOCOTON,OH 43812 US

LINE #	QTY	DESCRIPTION	REMARKS	UNIT PRICE	TOTAL
1	1.00	LOCATABLE MINERALS / MINING CLAIMS- NOT NEW-UNADJUD,ONE AUTH NO. ONLY / MINING CLAIM MONEY RECEIVED CASES: AMC426125/\$310.00		- n/a -	310.00
<b>TOTAL:</b>					<b>\$310.00</b>

PAYMENT INFORMATION			
NOTE: Items will appear on credit card statement as "BLM O Mining Claim".			
1	AMOUNT:	310.00	POSTMARKED: N/A
	TYPE:	CREDIT CARD	RECEIVED: 08/28/2017
	NAME:	KITTY DRUMM PO BOX 616 COSHOCOTON OH 43812 US	
	CARD NO:	XXXXXXXXXXXX0015	AUTH CODE: 083816
	NAME ON CARD:	KITTY DRUMM	
	EXPIRES:	01/2020	
	SIGNATURE:		

REMARKS

This receipt was generated by the automated BLM Collections and Billing System and is a paper representation of a portion of the official electronic record contained therein.

Run Date: 09/09/16

Run Time: 05:54 AM

**DEPARTMENT OF THE INTERIOR  
BUREAU OF LAND MANAGEMENT  
MINING CLAIMS**

**MC Maintenance Fees Paid Through the BLM Pay Portal**

**CBS Receipt: 3646199**

Printed For Lead File # **AMC426123**

Agency Tracking ID: 1472507524

Assessment Year: 2017

Number of BLM Serial Nr: 2

Paid On: 08/29/2016

Total Amount Paid: \$310.00

Claim Name	BLM Serial No	Lead File No	Amount Paid
LUCKY SEVEN DOWN	AMC426124	AMC426123	\$155.00
LUCKY SEVEN UP	AMC426125	AMC426123	\$155.00

**United States Department of the Interior**  
**Bureau of Land Management**  
 BUSINESS & SUPPORT SVCS DIV  
 ONE N CENTRAL AVE SUITE 800  
 PHOENIX, AZ 85004 -4427  
 Phone: (602) 417-9200

Receipt

No: 3646199

<b>Transaction #:</b> 3750180	
<b>Date of Transaction:</b> 08/29/2016	
CUSTOMER:	
KITTY S DRUMM PO BOX 616 COSHOCOTON,OH 43812 US	

LINE #	QTY	DESCRIPTION	REMARKS	UNIT PRICE	TOTAL
1	1.00	LOCATABLE MINERALS / MINING CLAIMS- NOT NEW-UNADJUD,ONE AUTH NO. ONLY / MINING CLAIM MONEY RECEIVED <b>CASES: AMC426125/\$310.00</b>		- n/a -	310.00
<b>TOTAL:</b>					<b>\$310.00</b>

PAYMENT INFORMATION			
NOTE: Items will appear on credit card statement as "BLM O Mining Claim".			
1	AMOUNT:	310.00	POSTMARKED: N/A
	TYPE:	CREDIT CARD	RECEIVED: 08/29/2016
	NAME:	KITTY S DRUMM PO BOX 616 COSHOCOTON OH 43812 US	
	CARD NO:	XXXXXXXXXXXX0015	AUTH CODE: 015317
	NAME ON CARD:	KITTY S DRUMM	
	EXPIRES:	01/2020	
	SIGNATURE:		

REMARKS

This receipt was generated by the automated BLM Collections and Billing System and is a paper representation of a portion of the official electronic record contained therein.

Run Date: 09/08/15

Run Time: 09:20 AM

**DEPARTMENT OF THE INTERIOR  
BUREAU OF LAND MANAGEMENT  
MINING CLAIMS**

**MC Maintenance Fees Paid Through the BLM Pay Portal**

**CBS Receipt: 3380566**

Printed For Lead File # AMC426123

Agency Tracking ID: 1440774010

Assessment Year: 2016

Number of BLM Serial Nr: 1

Paid On: 08/28/2015

Total Amount Paid: \$155.00

Claim Name	BLM Serial No	Lead File No	Amount Paid
SUGAR LOAF MINE	AMC426126	AMC426123	\$155.00

**United States Department of the Interior**  
**Bureau of Land Management**  
 BUSINESS & SUPPORT SVCS DIV  
 ONE N CENTRAL AVE SUITE 800  
 PHOENIX, AZ 85004 -4427  
 Phone: (602) 417-9200

Receipt

No: 3380566

<b>Transaction #:</b> 3478849	
<b>Date of Transaction:</b> 08/28/2015	
CUSTOMER:	
LISA CLOPTON 3478 CATCLAW DR PMB 228 ABILENE, TX 79606 US	

LINE #	QTY	DESCRIPTION	REMARKS	UNIT PRICE	TOTAL
1	1.00	LOCATABLE MINERALS / MINING CLAIMS- NOT NEW-UNADJUD, ONE AUTH NO. ONLY / MINING CLAIM MONEY RECEIVED CASES: AMC426126/\$155.00		- n/a -	155.00
<b>TOTAL:</b>					<b>\$155.00</b>

PAYMENT INFORMATION					
NOTE: Items will appear on credit card statement as "BLM O Mining Claim".					
1	AMOUNT:	155.00	POSTMARKED:	N/A	
	TYPE:	CREDIT CARD	RECEIVED:	08/28/2015	
	NAME:	LISA CLOPTON 3478 CATCLAW DR PMB 228 ABILENE TX 79606 US			
	CARD NO:	XXXXXXXXXXXX7147	AUTH CODE:	000011	
	NAME ON CARD:	LISA CLOPTON			
	EXPIRES:	08/2018			
	SIGNATURE:				

REMARKS

This receipt was generated by the automated BLM Collections and Billing System and is a paper representation of a portion of the official electronic record contained therein.



• Run Date: 08/27/15

Run Time: 08:15 AM

**DEPARTMENT OF THE INTERIOR  
BUREAU OF LAND MANAGEMENT  
MINING CLAIMS**

**MC Maintenance Fees Paid Through the BLM Pay Portal**

**CBS Receipt: 3375708**

Printed For Lead File # AMC426123

Agency Tracking ID: 1440438687

Assessment Year: 2016

Number of BLM Serial Nr: 1

Paid On: 08/24/2015

Total Amount Paid: \$155.00

Claim Name	BLM Serial No	Lead File No	Amount Paid
LUCKY SEVEN DOWN	AMC426124	AMC426123	\$155.00

**United States Department of the Interior**  
**Bureau of Land Management**  
 BUSINESS & SUPPORT SVCS DIV  
 ONE N CENTRAL AVE SUITE 800  
 PHOENIX, AZ 85004 -4427  
 Phone: (602) 417-9200

Receipt

No: 3375708

<b>Transaction #:</b> 3473936	
<b>Date of Transaction:</b> 08/24/2015	
CUSTOMER:	
JOHN DRUMM PO BOX 616 COSHOCOTON,OH 43812 US	

LINE #	QTY	DESCRIPTION	REMARKS	UNIT PRICE	TOTAL
1	1.00	LOCATABLE MINERALS / MINING CLAIMS- NOT NEW-UNADJUD,ONE AUTH NO. ONLY / MINING CLAIM MONEY RECEIVED CASES: AMC426124/\$155.00		- n/a -	155.00
<b>TOTAL:</b>					<b>\$155.00</b>

PAYMENT INFORMATION			
NOTE: Items will appear on credit card statement as "BLM O Mining Claim".			
1	AMOUNT:	155.00	POSTMARKED: N/A
	TYPE:	CREDIT CARD	RECEIVED: 08/24/2015
	NAME:	JOHN DRUMM PO BOX 616 COSHOCOTON OH 43812 US	
	CARD NO:	XXXXXXXXXXXX2431	AUTH CODE: 01109B
	NAME ON CARD:	JOHN DRUMM	
	EXPIRES:	06/2017	
	SIGNATURE:		

REMARKS

This receipt was generated by the automated BLM Collections and Billing System and is a paper representation of a portion of the official electronic record contained therein.

Run Date: 08/27/15

Run Time: 08:15 AM

**DEPARTMENT OF THE INTERIOR  
BUREAU OF LAND MANAGEMENT  
MINING CLAIMS**

**MC Maintenance Fees Paid Through the BLM Pay Portal**

**CBS Receipt: 3375706**

Printed For Lead File # AMC426123

Agency Tracking ID: 1440438041

Assessment Year: 2016

Number of BLM Serial Nr: 1

Paid On: 08/24/2015

Total Amount Paid: \$155.00

Claim Name	BLM Serial No	Lead File No	Amount Paid
LUCKY SEVEN UP	AMC426125	AMC426123	\$155.00

**United States Department of the Interior**  
**Bureau of Land Management**  
 BUSINESS & SUPPORT SVCS DIV  
 ONE N CENTRAL AVE SUITE 800  
 PHOENIX, AZ 85004 -4427  
 Phone: (602) 417-9200

Receipt

No: 3375706

<b>Transaction #:</b> 3473934	
<b>Date of Transaction:</b> 08/24/2015	
CUSTOMER:	
JOHN DRUMM PO BOX 616 COSHOCOTON,OH 43812 US	

LINE #	QTY	DESCRIPTION	REMARKS	UNIT PRICE	TOTAL
1	1.00	LOCATABLE MINERALS / MINING CLAIMS- NOT NEW-UNADJUD,ONE AUTH NO. ONLY / MINING CLAIM MONEY RECEIVED <b>CASES: AMC426125/\$155.00</b>		- n/a -	155.00
<b>TOTAL:</b>					<b>\$155.00</b>

PAYMENT INFORMATION			
NOTE: Items will appear on credit card statement as "BLM O Mining Claim".			
1	AMOUNT:	155.00	POSTMARKED: N/A
	TYPE:	CREDIT CARD	RECEIVED: 08/24/2015
	NAME:	JOHN DRUMM PO BOX 616 COSHOCOTON OH 43812 US	
	CARD NO:	XXXXXXXXXXXX2431	AUTH CODE: 25858B
	NAME ON CARD:	JOHN DRUMM	
	EXPIRES:	06/2017	
	SIGNATURE:		

REMARKS

This receipt was generated by the automated BLM Collections and Billing System and is a paper representation of a portion of the official electronic record contained therein.

426123

**NOTICE OF INTENTION TO HOLD MINING CLAIMS/SITES**

When Recorded Return Document to:

John DRUMM  
PO BOX 616  
COSHOCOTON, OHIO  
43812

BLM  
Date  
Stamp

RECEIVED  
2014 DEC - 8 P 3: 34  
PHOENIX, ARIZONA

Check here if this is a change of address.

Telephone: 252 343 6164

E-mail Address ~~MAMAJUG544@CENTURYLINK.NET~~

MAMAJUG544@CENTURYLINK.NET (mamajug544@centurylink.net)

I (We) intend to hold the claims(s) and/or site(s) listed below for the calendar year 20 15, and I (We) have filed or will file a Notice of Intent to Hold in the county where the claim (s) is located.

Reason for filing a Notice of Intent to Hold instead of an assessment work filing (check one):

- Maintenance fee was paid to maintain claim(s) during this assessment year.
- Mill or tunnel sites.
- Claim(s) was located during the current assessment year.
- BLM has deferred assessment work (attach copy of decision granting deferment, or pending petition for deferment including date petition was filed.)

Line No.	AMC NUMBER	CLAIM/SITE NAME	COUNTY RECORDER DATA (If available)	TWP	RNG	SEC
1	AMC 426125	LUCKY SEVEN UP				
2	AMC 426124	LUCKY SEVEN DOWN				
3						
4						
5						
6						
7						
8						
9						
10						

ENTERED  
DEC 10 2014  
BY: RAM

NOTICE OF INTENTION TO HOLD MINING CLAIMS/SITES  
page 2

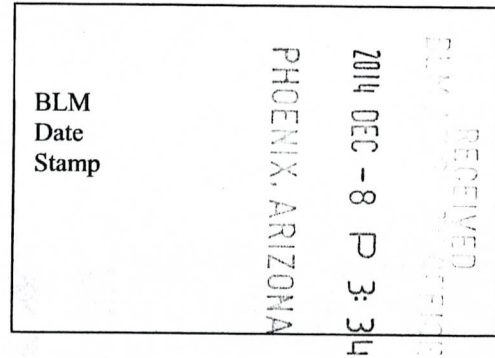

1. State of Arizona, County of LA PAZ

2. I (Name) John DRUMM

3. Reside at (Address) 33958 SR 93

City MILLERSBURG County COSHOCTON State OHIO Zip 44654 being duly sworn, depose and say that I am a citizen of the United States, more than eighteen years of age, that all of the facts set forth in this notice, subject to the provisions and penalties of 18 U.S.C. 1001 pertaining to the filing of false, fictitious, or fraudulent statements with the United States, are true and correct according to the best of my knowledge, information and belief.

4. Owner's name and address (If not shown in Items 1-3 above). \_\_\_\_\_

5. Dated: 11/17/2014 Signature: [Handwritten Signature]

Bureau of Land Management  
Arizona State Office  
[www.az.blm.gov](http://www.az.blm.gov)

No. of Claims: <u>2</u> x \$10 = <u>\$20.00</u>
Check No: <u>M.O.</u> Init. <u>A.H.</u>
Receipt No.: <u>3186591</u>
For BLM Use Only



Apply Priority Mail

RECEIVED

2014 DEC -8 P 3:35

PHOENIX, ARIZONA



1004

85004

U.S. POSTAGE  
PAID  
COSHOCTON, OH  
43812  
DEC 04, 14  
AMOUNT

\$5.75  
00061215-09

LAB400R Aug. 2013  
7690-17-000-0669

USPS TRACKING #



9114 9999 4423 8242 1182 46





UNITED STATES POSTAL SERVICE

# Mailing Envelope

Visit us at [usps.com](http://usps.com)



Recycled  
Paper

PLEASE PRESS FIRMLY

PLEASE PRESS FIRMLY

**Mail bearing stamp postage inside the mailer must be canceled by U.S. Postal Service prior to inserting into mailer.**

## HOW TO USE:

1. Place pre-addressed envelope inside this Priority Mail mailer
  - Make sure the address shows through the window
  - Any postage placed on the envelope must appear in the window area
  - Any postage applied to the envelope must be canceled by a USPS employee
2. Affix (appropriate) Priority Mail postage or meter strip to the front of the Priority Mail mailer
3. Seal flap on Priority Mail mailer envelope



Cradle to Cradle Certification is awarded to products that pursue an innovative vision of ecologically-intelligent design that eliminates the concept of waste. This USPS® packaging has been certified for its material content, recyclability, and manufacturing characteristics.

Please recycle.



EP14H



John DRUMM  
PO BOX 616  
COSHOCTON, OHIO  
43812



RECEIVED  
BLM AZ STATE OFFICE

2014 DEC -8 P 3:35

PHOENIX, ARIZONA

BUREAU OF LAND MANAGEMENT  
ARIZONA STATE OFFICE

ONE NORTH CENTRAL AVENUE, SUITE 800  
PHOENIX, AZ 85004-4427

United States Department of the Interior  
 Bureau of Land Management  
 LANDS/RECREATION & PLANNING  
 ONE N CENTRAL AVE  
 PHOENIX, AZ 85004 -2203  
 Phone: 602-417-9200

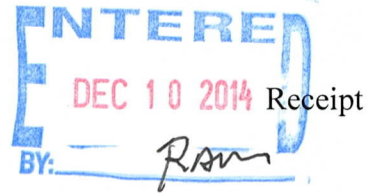

No: 3186591

<b>Transaction #:</b> 3279734	
<b>Date of Transaction:</b> 12/09/2014	
CUSTOMER:	
JOHN DRUMM PO BOX 616 COSHOCOTON, OH 43812-0616 US	

LINE #	QTY	DESCRIPTION	REMARKS	UNIT PRICE	TOTAL
1	1.00	LOCATABLE MINERALS / MINING CLAIMS- NOT NEW-UNADJUD, ONE AUTH NO. ONLY / MINING CLAIM MONEY RECEIVED CASES: AMC426125/\$20.00	NOI (2) 2014	- n/a -	20.00
<b>TOTAL:</b>					<b>\$20.00</b>

PAYMENT INFORMATION					
1	AMOUNT:	20.00	POSTMARKED:	12/04/2014	
	TYPE:	CHECK	RECEIVED:	12/08/2014	
	CHECK NO:	22178236948			
	NAME:	DRUMM, JOHN PO BOX 616 COSHOCOTON OH 43812-0616 US			

REMARKS

This receipt was generated by the automated BLM Collections and Billing System and is a paper representation of a portion of the official electronic record contained therein.

UNITED STATES  
DEPARTMENT OF THE INTERIOR  
BUREAU OF LAND MANAGEMENT  
**MAINTENANCE FEE PAYMENT FORM FOR  
LODE CLAIMS, MILL SITES, AND TUNNEL SITES** Amc 426123

Remitter Name: Robert E. Lane or Aracely Lane  
 Mailing Address: 1367 River Port Rd. ✓  
 City, State, Zip: Scranton Ar. 72863

Check here if this is a change of address.

**FOR COUNTY RECORDER'S USE**

No. of claims/sites \_\_\_\_\_  
 x \$140 per claim/site  
 Total due BLM \$ 155.<sup>00</sup>

- The maintenance fee may be paid by cash, check, money order, Bureau of Land Management (BLM) Declining Deposit Account, or credit card (VISA, American Express, Discover, or MasterCard). Payments must be remitted to the BLM State Office where your claim or site is recorded and received on or before September 1. If the payment is mailed, the envelope must be postmarked by a bona fide delivery service on or before September 1 and received at the proper BLM State Office within 15 calendar days after the due date. Payments may also be made by telephone using a credit card. A complete listing of BLM State Offices with their addresses and phone numbers can be found at <http://www.blm.gov>.
- The maintenance fee for the following claim(s)/site(s) applies to the assessment year Sept<sup>1</sup> 2014 → 2015

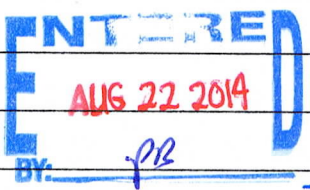
CLAIM/SITE NAME	BLM SERIAL NO.
<u>Humboldt</u>	<u># AMC 426123</u>
	RECEIVED BLM AZ STATE OFFICE PHOENIX, ARIZONA 2014 AUG 18 P 2 32
	

Use a separate sheet for additional claim/site names, serial numbers, and claimant names and addresses.

# 3105444



Mr. Robert Lane  
 1367 Riverport Rd  
 Scranton, AR 72873



RECEIVED  
 BLM AZ STATE OFFICE

2014 AUG 18 P 2:32

PHOENIX, ARIZONA

LITTLE ROCK AR 722

14 AUG 2014 PM 4 L



BLM Arizona  
 one North Central Avenue  
 Suite 800 Phoenix AZ.  
 85004

85004442700

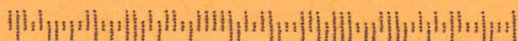

**United States Department of the Interior**  
**Bureau of Land Management**  
 LANDS/RECREATION & PLANNING  
 ONE N CENTRAL AVE  
 PHOENIX, AZ 85004 -2203  
 Phone: 602-417-9200

Receipt

No: 3105444

<b>Transaction #:</b> 3197086	<b>ENTERED INTO COMPUTER</b>
<b>Date of Transaction:</b> 08/19/2014	
<b>CUSTOMER:</b>	
ROBERT E LANE 1367 RIVERPORT RD SCRANTON, AR 72863-8932 US	

LINE #	QTY	DESCRIPTION	REMARKS	UNIT PRICE	TOTAL
1	1.00	LOCATABLE MINERALS / MINING CLAIMS- NOT NEW-UNADJUD, ONE AUTH NO. ONLY / MINING CLAIM MONEY RECEIVED <b>CASES: AMC426123/\$155.00</b>	MAINT 2015/1	- n/a -	155.00
<b>TOTAL:</b>					<b>\$155.00</b>

PAYMENT INFORMATION					
1	AMOUNT:	155.00	POSTMARKED:	08/11/2014	
	TYPE:	CHECK	RECEIVED:	08/18/2014	
	CHECK NO:	1488			
	NAME:	LANE, ARACELY 1367 RIVERPORT RD SCRANTON AR 72863-8932 US			

REMARKS

This receipt was generated by the automated BLM Collections and Billing System and is a paper representation of a portion of the official electronic record contained therein.

**NOTICE!!**

**These documents have been scanned!**

**Do not place un-scanned documents beneath this notice!**

**Do not remove this notice from this file!**

GPO Jacket No. 560-102  
Print Order 61540  
Rise Business Services, LLC  
Job=AZ15 5/10/2019



Box Number= AZ15035



Claim Begin-End: AMC426123-AMC426126

6 Location Notices-Amendments and Supporting Documents



AZ15035-15

AMC425596-AMC426147

**MINING CLAIM STATUS REPORT**

Data Entered: 1/21/2014 RM

MTP Checked By: RM  
GEO Checked By: RM

LEAD SERIAL NUMBER: AMC 426123 thru AMC 426126

**NUMBER OF CLAIMS & TYPE:**

4 LODE  
PLACER  
ASSOCIATION PLACER  
MILL SITE  
TUNNEL SITE

**CHARGES:**

Location Fee @ \$34 = \$ 136.  
Processing Fee @ \$20 = \$ 80  
Maintenance Fee @ \$140 = \$ 560  
Add'l Maint Fee for Assoc Placer = \$  
**SUBTOTAL** \$  
Other Fees \$  
Other Fees \$  
**TOTAL** \$ 776.00

TOTAL ACREAGE: \_\_\_\_\_ Per Claim  
(Placer Only)

NUMBER OF LOCATORS: \_\_\_\_\_

DOCUMENTS RECEIVED VIA : Over-the-Counter [ ] Mail [ ] **TIMELY FILED:** Yes [ ] No [ ]

LEGAL DESCRIPTION: T 7N R 13W SEC 13, 12, 14  
T 7N R 16W SEC 16, 21  
T \_\_\_\_\_ R \_\_\_\_\_ SEC \_\_\_\_\_  
T \_\_\_\_\_ R \_\_\_\_\_ SEC \_\_\_\_\_  
T \_\_\_\_\_ R \_\_\_\_\_ SEC \_\_\_\_\_

BLM [ ] FOREST SERVICE [ ] \_\_\_\_\_ SUBJ TO PL 359: Yes [ ] No [ ]  
WILDERNESS AREA [ ] \_\_\_\_\_

SPLIT ESTATE: N/A [ ] SX [ ] PX [ ] OTHER [ ] \_\_\_\_\_  
SRHA [ ] Was proper Notice filed if located on SHRA Land? Yes [ ] No [ ]

RECONVEYED MINERALS ON BLM LAND REQUIRE OPENING ORDER FROM 1944 TO 1993:  
Open to Entry On \_\_\_\_\_ N/A [ ]

COMMENTS/STATUS: VOID [ ] PARTIALLY VOID [ ] PVT MINERALS [ ] WITHDRAWN LANDS [ ]  
OTHER [ ] \_\_\_\_\_

[ ] Claimant acknowledges that portions of the following claim(s) site(s) may be void or voidable.

Printed Name of Claimant \_\_\_\_\_ Signature of Claimant \_\_\_\_\_

\*\*\*\*\*FINAL ADJUDICATION\*\*\*\*\*

DATE 6/26/2014 INITIALS RM  
AT

AM0426123

RECORDING REQUESTED BY:

(Mail recording to;)

Department of Land

Transfer Information, Inc.

942 Calle Amanecer, Suite B

San Clemente, CA 92673

FOR RECORDER'S USE

**LOCATION NOTICE FOR LODE MINING CLAIM**

NOTICE IS HEREBY GIVEN that the **HUMBOLDT** lode mining claim has been located by Department of Land Transfer Information, Inc., a Wyoming Corporation whose current mailing address is 942 Calle Amanecer, Suite B, San Clemente, CA 92673.

The general course of this claim is North and South and it is situated in the Gila Salt River Meridian, La Paz County, Arizona.

This claim is 600 feet in length and 1,500 feet in width. This claim runs from the location monument on which this location notice is posted approximately 1,200 feet in a Northerly direction to the North end line and approximately 300 feet in a Southerly direction to the South end line.

This claim is marked by four (4) monuments, one at each corner of the claim. Additionally, there are two (2) end-line markers on each side of the center of the claim. All markers are 4" x 4" wooden posts that are buried 1.5' in the ground and protrude 4.5' above the ground embossed with the name of the claim and its location in relation to the claim.

The location monument on which this notice is posted is situated within Section 21, Township 7N, Range 16W, Gila Salt River Meridian, La Paz County Arizona and this claim encompasses portions of the following quarter section (s), Township (s) and Range (s); SW 1/4 of NE 1/4 and NW 1/4 of SE 1/4 of Section 21, T7N, R16W, Gila Salt River Meridian, La Paz County Arizona.

The locality of this claim with reference to some natural object or permanent monument and additional information (if any) concerning its locality are as follows: SE corner of this claim is 470 Feet North and 0 Feet West of the SE corner of NW 1/4 of SE 1/4 Section 21, T7N, R16W.

DATED AND POSTED on the ground this 1<sup>st</sup> day of November, 2013.

Locator of this lode mining claim is:

**DEPARTMENT OF LAND TRANSFER INFORMATION, INC.**



Steven L. Cyros, President

Authorized Officer for DEPARTMENT OF LAND TRANSFER INFORMATION, INC.

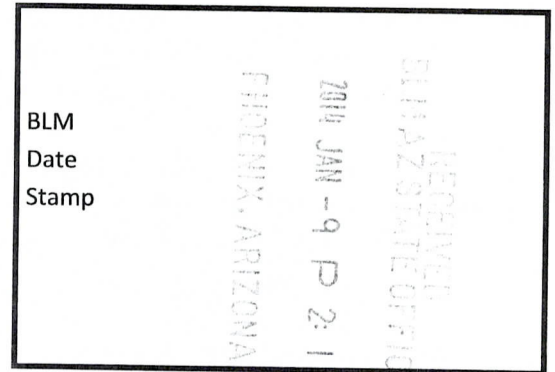

AMC426123



# MINING CLAIM MAP

- 1) Name of Claim; **HUMBOLDT**
- 2) Type of Claim; **LODE**
- 3) Location Monument is located in Section 21, Township 7N, Range 16W, Gila Salt River Meridian, La Paz County, Arizona.
- 4) The types of corner and location monuments used are as follows: 4" X 4" Wooden Posts.

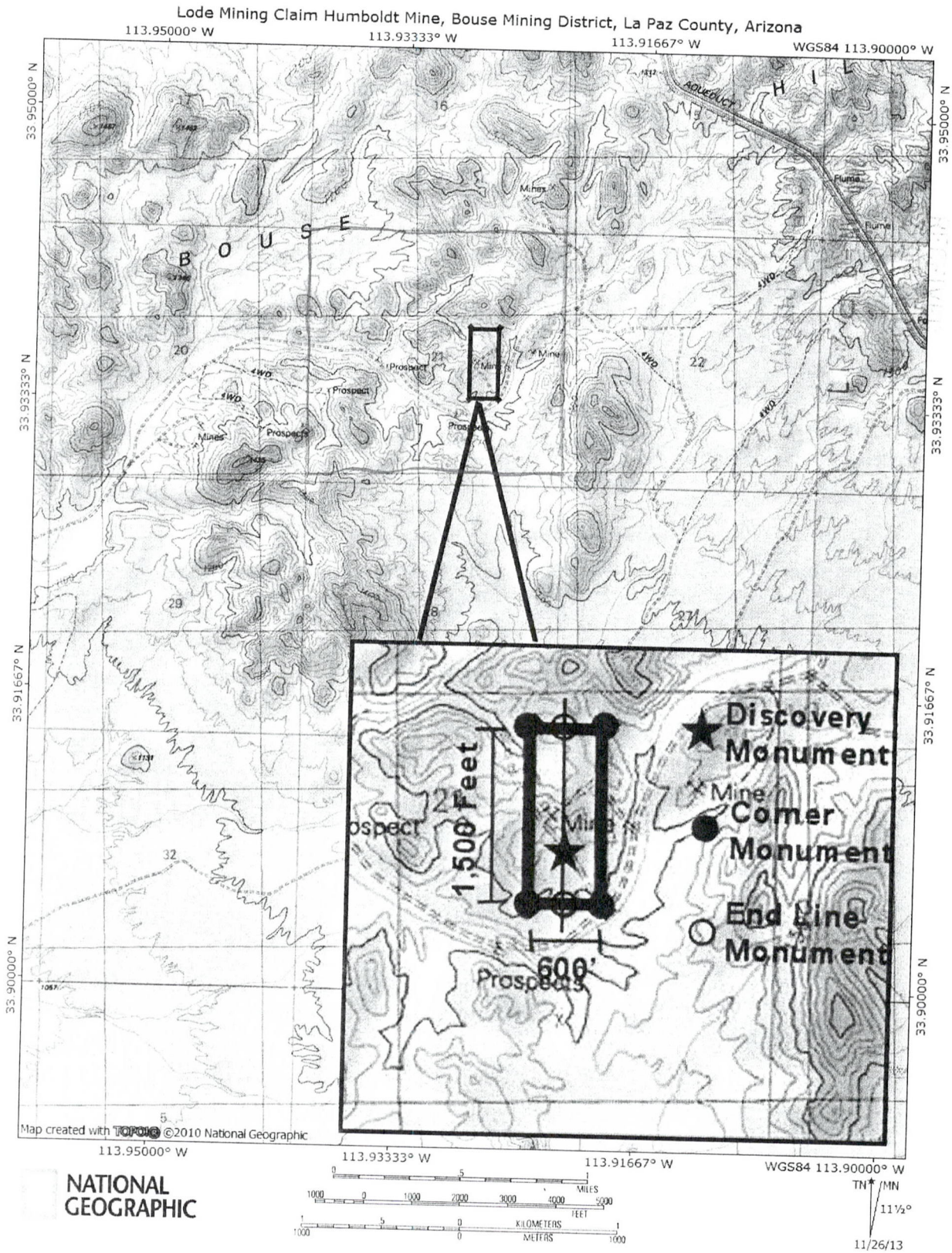

ANCH25123

RECORDING REQUESTED BY:

(Mail recording to;)

Department of Land

Transfer Information, Inc.

942 Calle Amanecer, Suite B

San Clemente, CA 92673

FOR RECORDER'S USE

**LOCATION NOTICE FOR LODE MINING CLAIM**

NOTICE IS HEREBY GIVEN that the **LUCKY SEVEN DOWN** lode mining claim has been located by Department of Land Transfer Information, Inc., a Wyoming Corporation whose current mailing address is 942 Calle Amanecer, Suite B, San Clemente, CA 92673.

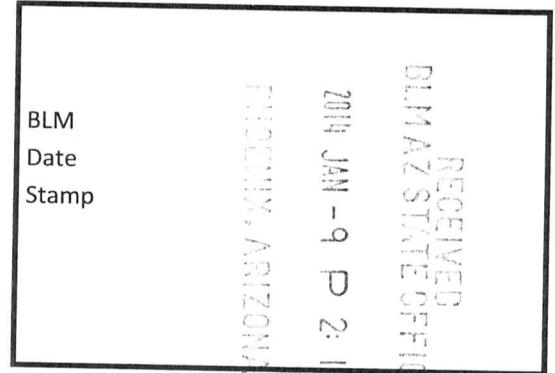

The general course of this claim is North and South and it is situated in the Gila Salt River Meridian, La Paz County, Arizona.

This claim is 600 feet in length and 1,500 feet in width. This claim runs from the location monument on which this location notice is posted approximately 1,200 feet in a Northerly direction to the North end line and approximately 300 feet in a Southerly direction to the South end line.

This claim is marked by four (4) monuments, one at each corner of the claim. Additionally, there are two (2) end-line markers on each side of the center of the claim. All markers are 4" x 4" wooden posts that are buried 1.5' in the ground and protrude 4.5' above the ground embossed with the name of the claim and its location in relation to the claim.

The location monument on which this notice is posted is situated within Section 13, Township 7N, Range 13W, Gila Salt River Meridian, La Paz County Arizona and this claim encompasses portions of the following quarter section (s), Township (s) and Range (s); NE 1/4 of NE 1/4 and SE 1/4 of NE 1/4 of Section 14, T7N, R13W and NW 1/4 of NW 1/4 and SW 1/4 of NW 1/4 of Section 13, T7N, R13W, Gila Salt River Meridian, La Paz County Arizona.

The locality of this claim with reference to some natural object or permanent monument and additional information (if any) concerning its locality are as follows: NW corner of this claim is 360 Feet South and 120 Feet West of the NW corner of Section 13, T7N, R13W.

DATED AND POSTED on the ground this 1st day of November, 2013.

Locator of this lode mining claim is:

**DEPARTMENT OF LAND TRANSFER INFORMATION, INC.**

Steven L. Cyros, President

Authorized Officer for DEPARTMENT OF LAND TRANSFER INFORMATION, INC.

ANCH 26124

# MINING CLAIM MAP

- 1) Name of Claim; **LUCKY SEVEN DOWN**
- 2) Type of Claim; **LODE**
- 3) Location Monument is located in Section 13, Township 7N, Range 13W, Gila Salt River Meridian, La Paz County, Arizona.
- 4) The types of corner and location monuments used are as follows: 4" X 4" Wooden Posts.

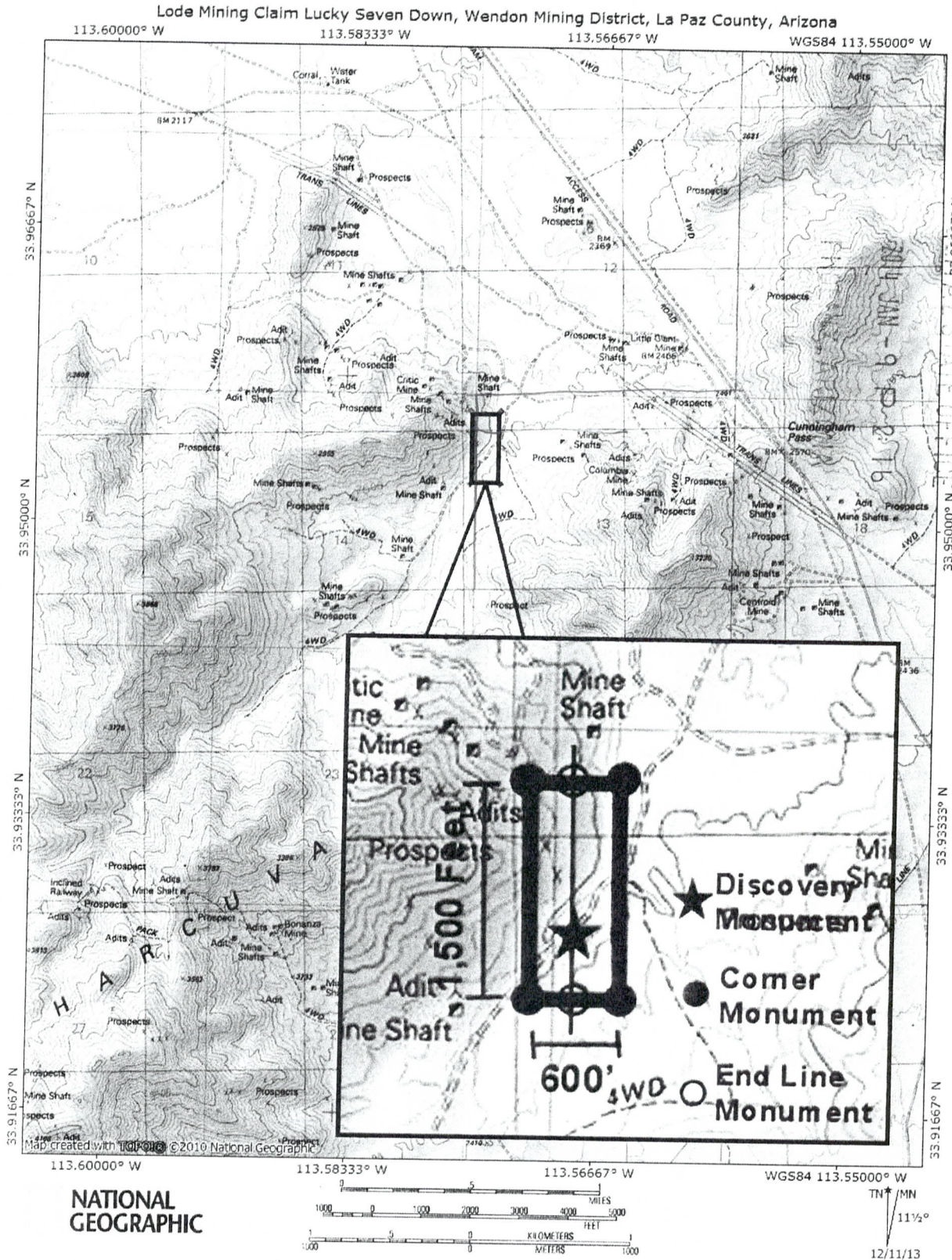

A1101126124

RECORDING REQUESTED BY:

(Mail recording to;)

Department of Land

Transfer Information, Inc.

942 Calle Amanecer, Suite B

San Clemente, CA 92673

FOR RECORDER'S USE

### LOCATION NOTICE FOR LODE MINING CLAIM

NOTICE IS HEREBY GIVEN that the **LUCKY SEVEN UP** lode mining claim has been located by Department of Land Transfer Information, Inc., a Wyoming Corporation whose current mailing address is 942 Calle Amanecer, Suite B, San Clemente, CA 92673.

The general course of this claim is North and South and it is situated in the Gila Salt River Meridian, La Paz County, Arizona.

This claim is 600 feet in length and 1,500 feet in width. This claim runs from the location monument on which this location notice is posted approximately 1,200 feet in a Northerly direction to the North end line and approximately 300 feet in a Southerly direction to the South end line.

This claim is marked by four (4) monuments, one at each corner of the claim. Additionally, there are two (2) end-line markers on each side of the center of the claim. All markers are 4" x 4" wooden posts that are buried 1.5' in the ground and protrude 4.5' above the ground embossed with the name of the claim and its location in relation to the claim.

The location monument on which this notice is posted is situated within Section 12, Township 7N, Range 13W, Gila Salt River Meridian, La Paz County Arizona and this claim encompasses portions of the following quarter section (s), Township (s) and Range (s); SW 1/4 of SW 1/4 of Section 12, T7N, R13W and NW 1/4 of NW 1/4 of Section 13, T7N, R13W, Gila Salt River Meridian, La Paz County Arizona.

The locality of this claim with reference to some natural object or permanent monument and additional information (if any) concerning its locality are as follows: SW corner of this claim is 360 Feet South and 0 Feet East of the SW corner of Section 12, T7N, R13W.

DATED AND POSTED on the ground this 1<sup>st</sup> day of November, 2013.

Locator of this lode mining claim is:

**DEPARTMENT OF LAND TRANSFER INFORMATION, INC.**



Steven L. Cyros, President

Authorized Officer for DEPARTMENT OF LAND TRANSFER INFORMATION, INC.

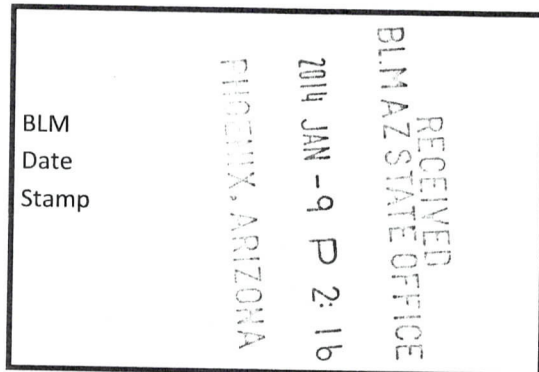

AMG425125

# MINING CLAIM MAP

- 1) Name of Claim; **LUCKY SEVEN UP**
- 2) Type of Claim; **LODE**
- 3) Location Monument is located in Section 12, Township 7N, Range 13W, Gila Salt River Meridian, La Paz County, Arizona.
- 4) The types of corner and location monuments used are as follows: 4" X 4" Wooden Posts.

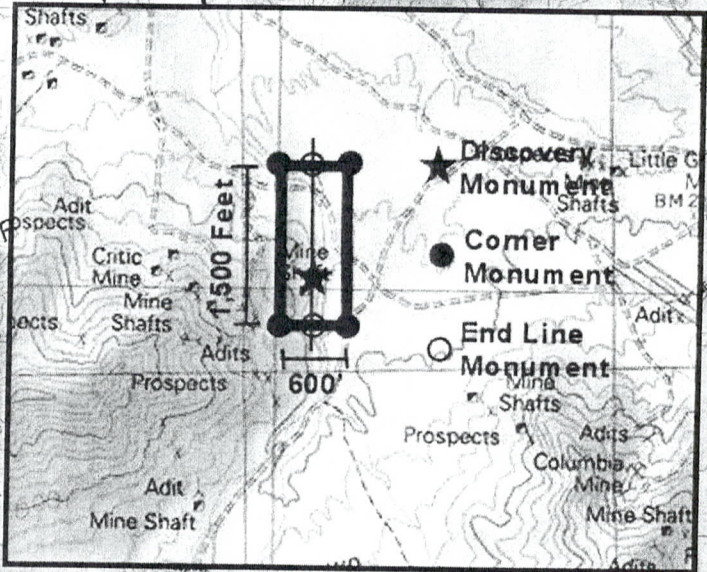
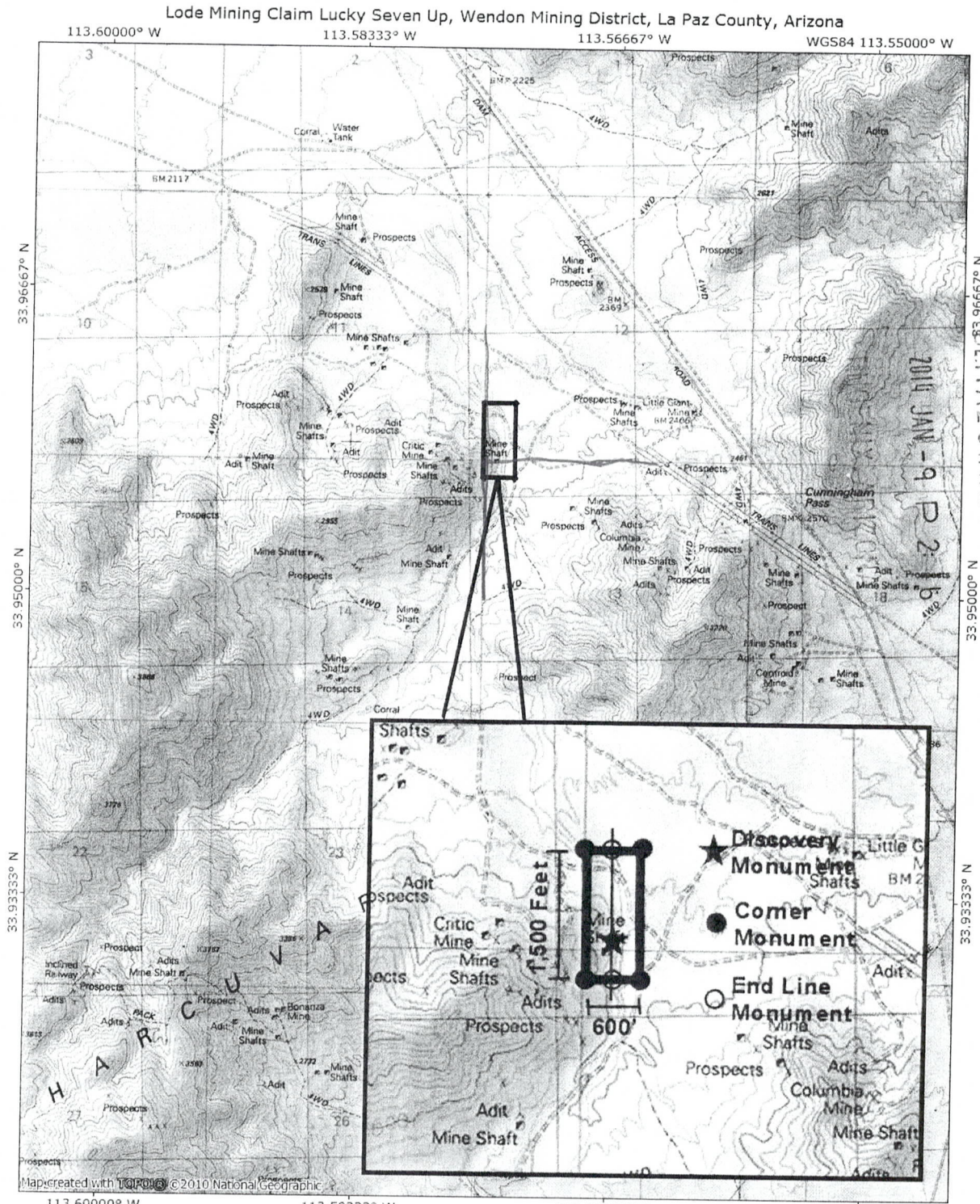

RECEIVED  
 BLM AZ STATE OFFICE  
 2014 JAN -9 P 2 B  
 N 49996 E S  
 N 0006 E S

A10426125

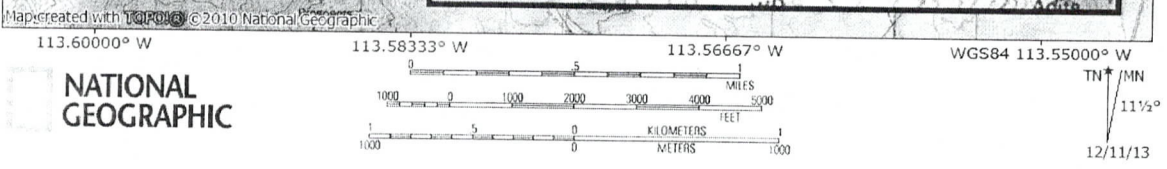

**NATIONAL GEOGRAPHIC**

RECORDING REQUESTED BY:  
(Mail recording to;)  
Department of Land  
Transfer Information, Inc.  
942 Calle Amanecer, Suite B  
San Clemente, CA 92673

FOR RECORDER'S USE

### LOCATION NOTICE FOR LODE MINING CLAIM

NOTICE IS HEREBY GIVEN that the **SUGAR LOAF MINE** lode mining claim has been located by Department of Land Transfer Information, Inc., a Wyoming Corporation whose current mailing address is 942 Calle Amanecer, Suite B, San Clemente, CA 92673.

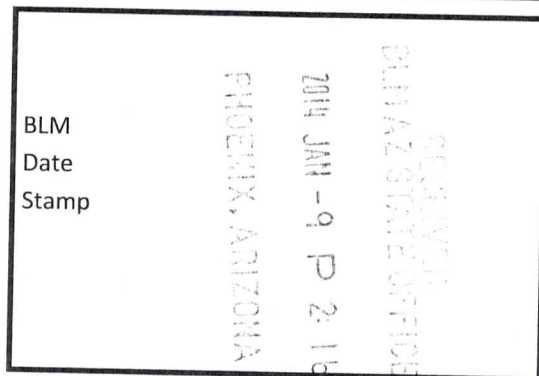

The general course of this claim is East and West and it is situated in the Gila Salt River Meridian, La Paz County, Arizona.

This claim is 1,500 feet in length and 600 feet in width. This claim runs from the location monument on which this location notice is posted approximately 1,200 feet in an Easterly direction to the East end line and approximately 300 feet in a Southerly direction to the South end line.

This claim is marked by four (4) monuments, one at each corner of the claim. Additionally, there are two (2) end-line markers on each side of the center of the claim. All markers are 4" x 4" wooden posts that are buried 1.5' in the ground and protrude 4.5' above the ground embossed with the name of the claim and its location in relation to the claim.

The location monument on which this notice is posted is situated within Section 16, Township 7N, Range 16W, Gila Salt River Meridian, La Paz County Arizona and this claim encompasses portions of the following quarter section (s), Township (s) and Range (s); SE 1/4 of SE 1/4 and SW 1/4 of SE 1/4 of Section 16, T7N, R16W, Gila Salt River Meridian, La Paz County Arizona.

The locality of this claim with reference to some natural object or permanent monument and additional information (if any) concerning its locality are as follows: SE corner of this claim is 570 Feet North and 0 Feet West of the SE corner of Section 16, T7N, R16W.

DATED AND POSTED on the ground this 1<sup>st</sup> day of November, 2013.

Locator of this lode mining claim is:

**DEPARTMENT OF LAND TRANSFER INFORMATION, INC.**

Steven L. Cyros, President

Authorized Officer for DEPARTMENT OF LAND TRANSFER INFORMATION, INC.

ATC 20120

# MINING CLAIM MAP

- 1) Name of Claim; **SUGAR LOAF MINE**
- 2) Type of Claim; **LODE**
- 3) Location Monument is located in Section 16, Township 7N, Range 16W, Gila Salt River Meridian, La Paz County, Arizona.
- 4) The types of corner and location monuments used are as follows: 4" X 4" Wooden Posts.

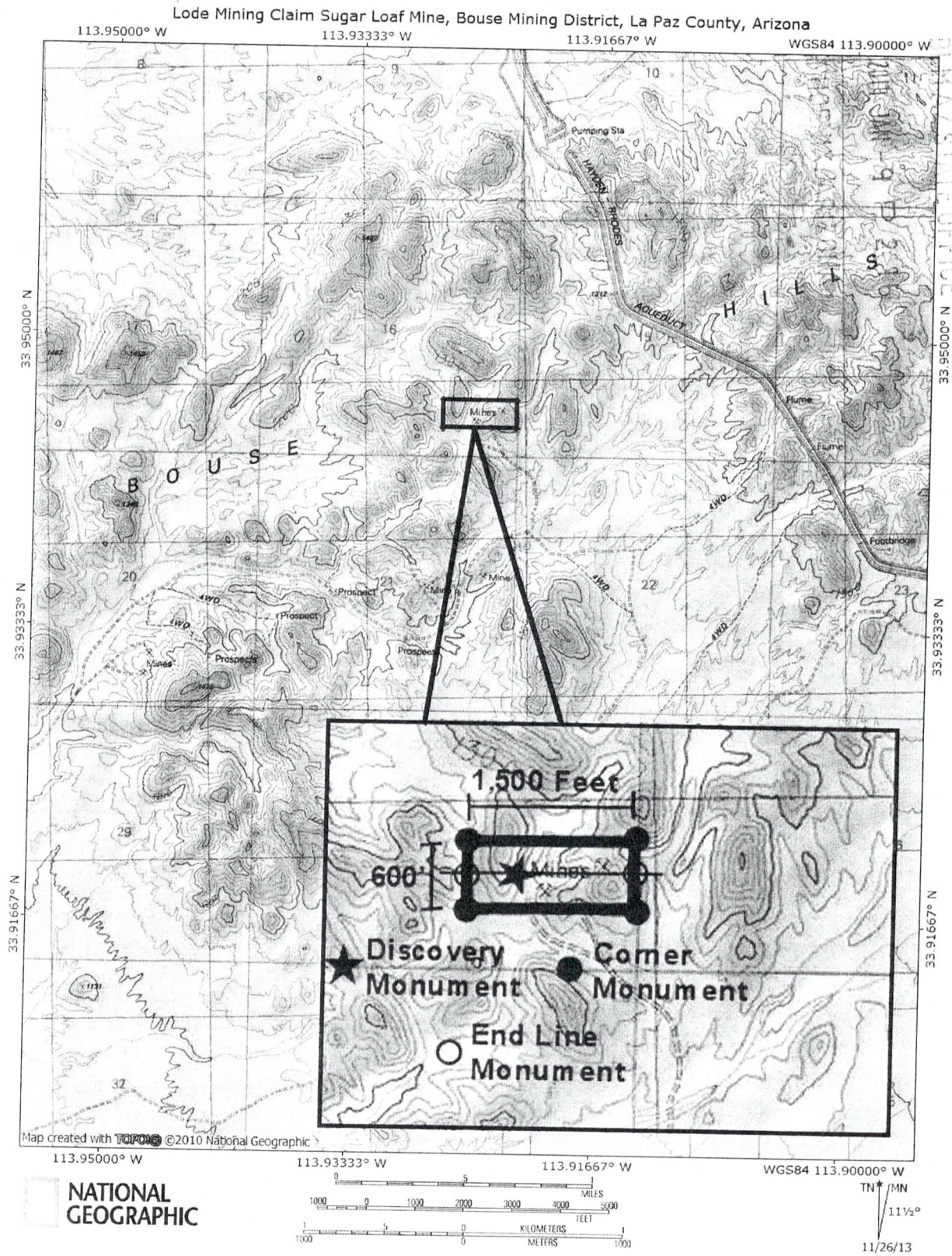

A110426126

DEPARTMENT OF INTERIOR  
BUREAU OF LAND MANAGEMENT

Input Parameters for Geographic Report with Land

System Id = CR

Admin State = AZ

Geo State =

Casetype Begins With

Case Disp Txt = AUTHORIZED, CANCELLED, EXPIRED, PENDING, REJECTED, RELINQUISHED, VOID, WITHDRAWN

Mer Twp Rng = 14 0070N 0160W

Section = 016, 021, 999

Mtrs =

Commodity =

Commodity Txt =

Pending Org =

Pend Org Decode =

Total Rows Returned: 1



DEPARTMENT OF INTERIOR  
BUREAU OF LAND MANAGEMENT

Input Parameters for Geographic Report with Land

System Id = CR

Admin State = AZ

Geo State =

Casetype Begins With

Case Disp Txt = AUTHORIZED, CANCELLED, EXPIRED, PENDING, REJECTED, RELINQUISHED, VOID, WITHDRAWN

Mer Twp Rng = 14 0070N 0130W

Section = 012, 013, 014, 999

Mtrs =

Commodity =

Commodity Txt =

Pending Org =

Pend Org Decode =

Total Rows Returned: 21

RUN TIME: 06:02 PM

UNITED STATES DEPARTMENT OF INTERIOR  
BUREAU OF LAND MANAGEMENT  
GEOGRAPHIC REPORT WITH LAND  
Sorted by Serial Number

RUN DATE: 01/21/2014  
Page 2 of 2

Adm State: AZ

013 LOTS 2,3;  
LOTS 1;

Serial Number: AZPHX 0080582  
Total Case Acres: 1,158.300

<u>Casetype</u>	<u>Case Disp</u>	14	0070N	0130W	<u>Sect</u>	<u>Sur Typ</u>	<u>Sur Num</u>	<u>Suff</u>	<u>Subdivision</u>	<u>Act Pend</u>
285004	AUTHORIZED				012	ALIQ			S2;	
					013	ALIQ			N2NE;	

Serial Number: AZPHX 0082297  
Total Case Acres: 1.000

<u>Casetype</u>	<u>Case Disp</u>	14	0070N	0130W	<u>Sect</u>	<u>Sur Typ</u>	<u>Sur Num</u>	<u>Suff</u>	<u>Subdivision</u>	<u>Act Pend</u>
285007	AUTHORIZED				012	ALIQ			NWSW;	
						LOTS			4,7,8;	
					013	LOTS			1,2;	

Serial Number: AZPHX 0086056  
Total Case Acres: 542.590

<u>Casetype</u>	<u>Case Disp</u>	14	0070N	0130W	<u>Sect</u>	<u>Sur Typ</u>	<u>Sur Num</u>	<u>Suff</u>	<u>Subdivision</u>	<u>Act Pend</u>
288100	AUTHORIZED				012	ALIQ			NENW;	
						LOTS			2,3;	

RUN TIME: 06:02 PM

UNITED STATES DEPARTMENT OF INTERIOR  
BUREAU OF LAND MANAGEMENT  
GEOGRAPHIC REPORT WITH LAND  
Sorted by Serial Number

RUN DATE: 01/21/2014  
Page 1 of 2

Adm State: AZ

Serial Number: AZA 010987  
Total Case Acres: 1,409.100

<u>Casetype</u>	<u>Case Disp</u>	14	0070N	0130W	<u>Sect</u>	<u>Sur Typ</u>	<u>Sur Num</u>	<u>Suff</u>	<u>Subdivision</u>	<u>Act Pend</u>
285003	AUTHORIZED				012	ALIQ			NWSW;	
					013	LOTS			4,7,8;	
									1,2;	

Serial Number: AZA 013875  
Total Case Acres: 524.080

<u>Casetype</u>	<u>Case Disp</u>	14	0070N	0130W	<u>Sect</u>	<u>Sur Typ</u>	<u>Sur Num</u>	<u>Suff</u>	<u>Subdivision</u>	<u>Act Pend</u>
285003	AUTHORIZED				012	ALIQ			NWSW;	
					013	LOTS			4,7,8,9;	
									1,2;	

Serial Number: AZA 027844  
Total Case Acres: 85.660

<u>Casetype</u>	<u>Case Disp</u>	14	0070N	0130W	<u>Sect</u>	<u>Sur Typ</u>	<u>Sur Num</u>	<u>Suff</u>	<u>Subdivision</u>	<u>Act Pend</u>
286203	AUTHORIZED				012	ALIQ			NENW;	
								1	2,3;	

Serial Number: AZA 030316  
Total Case Acres: 141.530

<u>Casetype</u>	<u>Case Disp</u>	14	0070N	0130W	<u>Sect</u>	<u>Sur Typ</u>	<u>Sur Num</u>	<u>Suff</u>	<u>Subdivision</u>	<u>Act Pend</u>
286203	AUTHORIZED				012	ALIQ			NWSW;	
					013	LOTS			4,7,8;	
									1,2;	

Serial Number: AZA 033197  
Total Case Acres: 48.623

<u>Casetype</u>	<u>Case Disp</u>	14	0070N	0130W	<u>Sect</u>	<u>Sur Typ</u>	<u>Sur Num</u>	<u>Suff</u>	<u>Subdivision</u>	<u>Act Pend</u>
285003	AUTHORIZED				012	ALIQ			N2NW,SE;	

RUN TIME: 05:43 PM

UNITED STATES DEPARTMENT OF INTERIOR  
BUREAU OF LAND MANAGEMENT  
GEOGRAPHIC REPORT WITH LAND  
Sorted by Serial Number

RUN DATE: 01/21/2014  
Page 1 of 1

Adm State: AZ

Serial Number: AZA 017672  
Total Case Acres: 0.030

<u>Casetype</u>	<u>Case Disp</u>				<u>Sect</u>	<u>Sur Typ</u>	<u>Sur Num</u>	<u>Suff</u>	<u>Subdivision</u>	<u>Act Pend</u>
286007	AUTHORIZED	14	0070N	0160W	016	ALIQ			NENE;	







DEPARTMENT OF LAND TRANSFER INFORMATION  
PROTECTING AMERICA'S RESOURCES

STEVEN L. CYROS  
SUPERVISORY FIELD AGENT

942 CALLE AMANECEP  
BLDG. B / MS 548  
SAN CLEMENTE, CA 92673  
TEL (949) 366-9484  
FAX (949) 366-9943  
SCYROS@DETL.US.COM  
WWW.LANDTRANSFER.US.COM

January 6, 2014

Bureau of Land Management  
Arizona State Office  
One Central Avenue  
Suite 800  
Phoenix, AZ 85004-4427

RE: Location Notices/Filings for Mining Claim and payment on the following new Mining Claims;

1. **LUCKY SEVEN UP** Mining Claim
2. **LUCKY SEVEN DOWN** Mining Claim
3. **SUGAR LOAF MINE** Mining Claim
4. **HUMBOLDT** Mining Claim

To Whom It May Concern:

Enclosed, please find my check payable to Department of the Interior/BLM for payment in the amount of \$776.00 for the processing of the following four (4) location notices/new mining claims (4 claims X \$194.00/Each), as well as the signed location notices dated on November 1<sup>st</sup> of 2013 and a copy of the respective location maps.

Should you need any additional information, please do not hesitate to call on me.

Warmest Regards,

Steven L. Cyros, President

RECEIVED  
BLM AZ STATE OFFICE  
2014 JAN -9 P 2:16  
PHOENIX, ARIZONA

AN0426123

**Extremely Urgent**

This envelope is for use with the following services:

- UPS Next Day Air®
- UPS Worldwide Express®
- UPS 2nd Day Air®

Apply shipping documents on this side.

Do not use this envelope for:

- UPS Ground
- UPS Standard
- UPS 3 Day Select®

Visit **ups.com**® or call **1-800-PICK-UPS**® (1-800-742-5877) to schedule a pickup or find a drop off location near you.

**Domestic Shipments**

- To qualify for the Letter rate, UPS Express Envelopes may only contain correspondence, urgent documents, and/or electronic media, and must weigh 8 oz. or less. UPS Express Envelopes containing items other than those listed or weighing more than 8 oz. will be billed by weight.

**International Shipments**

- The UPS Express Envelope may be used only for documents of no commercial value. Certain countries consider electronic media as documents. Visit [ups.com/importexport](http://ups.com/importexport) to verify if your shipment is classified as a document.
- To qualify for the Letter rate, the UPS Express Envelope must weigh 8 oz. or less. UPS Express Envelopes weighing more than 8 oz. will be billed by weight.

**Note:** Express Envelopes are not recommended for shipments of electronic media containing sensitive personal information or breakable items. Do not send cash or cash equivalent.

STEVEN CYROS  
 (949) 368-9494  
 FTF TECHNOLOGIES, INC.  
 942 CALLE AMANECER, SUITE B  
 SAN CLEMENTE CA 92673-6220

LTR 1 OF 1

**SHIP TO:**  
 ARIZONA STATE OFFICE  
 (602) 417-9200  
 BUREAU OF LAND MANAGEMENT  
 SUITE 800  
 ONE CENTRAL AVENUE  
 PHOENIX AZ 85004-4427

 **AZ 850 9-10**  

**UPS 2ND DAY AIR** **2**  
 TRACKING #: 1Z 614 Y2R 02 6873 8447



BILLING: P/P

HS 16.0.31 45.0A 10/2013

SEE NOTICE ON REVERSE regarding UPS Terms, and notice of limitation of liability. Where allowed by law, shipper authorizes UPS to act as forwarding agent for export control and customs purposes. If exported from the US, shipper certifies that the commodities, technology or software were exported from the US in accordance with the Export Administration Regulations. Diversion contrary to law is prohibited.

PHOENIX, ARIZONA  
 2014 JAN -9 P 2:16  
 RECEIVED  
 BLM AZ STATE OFFICE

International Shipping Notice — Carriage hereunder may be subject to the rules relating to liability and other terms and/or conditions established by the Convention for the Unification of Certain Rules Relating to the International Carriage of Goods by Road (the "CMR Convention"). These commodities, technology or software were exported from the U.S. in accordance with the Export Administration Regulations.





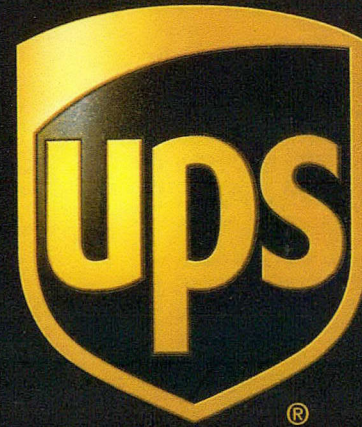

1 N CENTRAL AVE  
STE 800  
PHOENIX AZ 85004-4414

**P: PURPLE S: ORANGE I: 43D**

**0905-6070**

1Z614Y2R026873 8447

SAT08485 Jan 09 04:48:18 2014  
US 8501 H1PPS 13.1.1 SAT08485SL

Synchronizing the world of commerce<sup>SM</sup>

# Express Envelope